

Type: Submersible mixer  
 Application: Prevent the accumulation of solids and floating crusts.

## Mixer

Effective area up to Ø6m  
 Impeller diameter 115mm  
 Electrical power in clean water 1.8 kW  
 Weight 44 kg

## Motor

Mains: 50Hz – 3 phase  
 Rated shaft power (P2) 1.5 kW  
 Absorbed electrical power (P1) 2.1 kW  
 Nominal speed 1420 rpm  
 Motor efficiency 71 %  
 Power factor (cos phi) 0.84  
 Degree of protection IP 68  
 Isolation class F (155°C)  
 Max. water temperature 40°C  
 Standard cable length 10 m



## Materials

Impeller AISI 329  
 Motor unit parts AISI 329  
 Pump shaft AISI 316  
 Pump support AISI 316  
 Bolts AISI 316  
 Rubber parts Viton (FPM)  
 Electrical cable Neoprene (CR)  
 Seal lubrication Oil  
 Seal pump side Silicon carbide – silicon carbide-Viton  
 Seal motor side Carbon - ceramic

## Optional

- Flameproof version, to class: II 2 G Ex d IIB c T4  
 Standard: II 2 G Ex b c d IIB T4 Gb  
 With Frequency control: II 2 G Ex b c d IIB T3 Gb
- Thermo switches in motor windings  
 (standard for flameproof version)
- Cable protection sheet (AISI316)
- Water detector in motor and oil chamber  
 Flameproof version with external cable
- Heavy duty support (AISI316)

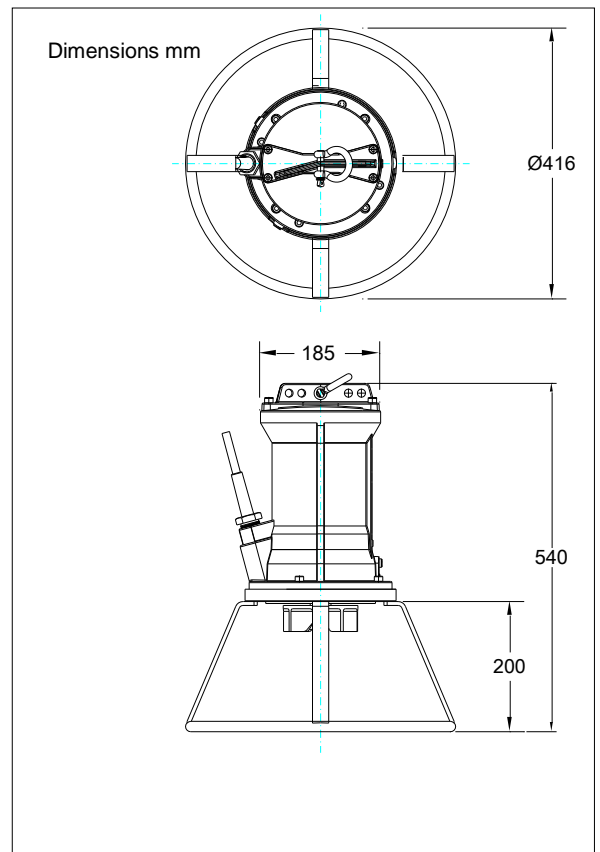

## Connections

voltage	current	electrical cable size		motor protection and/or water detector		flameproof version		
		direct start		direct start		direct start		
230	6.3	4G1.5		7G1.5		7G1.5		
400	3.6	4G1.5		7G1.5		7G1.5		
500	2.9	4G1.5		7G1.5		7G1.5		
starting current DOL start : 4.8 x rated current								
							* other voltages on request	

Type: Submersible mixer  
 Application: Prevent the accumulation of solids and floating crusts.

## Mixer

Effective area up to Ø8m  
 Impeller diameter 125mm  
 Electrical power in clean water 2.5 kW  
 Weight 44 kg

## Motor

Mains: 50Hz – 3 phase  
 Rated shaft power (P2) 2.2 kW  
 Absorbed electrical power (P1) 3.1 kW  
 Nominal speed 1375 rpm  
 Motor efficiency 71 %  
 Power factor (cos phi) 0.89  
 Degree of protection IP 68  
 Isolation class F (155°C)  
 Max. water temperature 40°C  
 Standard cable length 10 m



## Materials

Impeller AISI 329  
 Motor unit parts AISI 329  
 Pump shaft AISI 316  
 Pump support AISI 316  
 Bolts AISI 316  
 Rubber parts Viton (FPM)  
 Electrical cable Neoprene (CR)  
 Seal lubrication Oil  
 Seal pump side Silicon carbide – silicon carbide-Viton  
 Seal motor side Carbon - ceramic

## Optional

- Flameproof version, to class: II 2 G Ex d IIB c T4  
 Standard: II 2 G Ex b c d IIB T4 Gb  
 With Frequency control: II 2 G Ex b c d IIB T3 Gb
- Thermo switches in motor windings  
 (standard for flameproof version)
- Cable protection sheet (AISI316)
- Water detector in motor and oil chamber  
 Flameproof version with external cable
- Heavy duty support (AISI316)

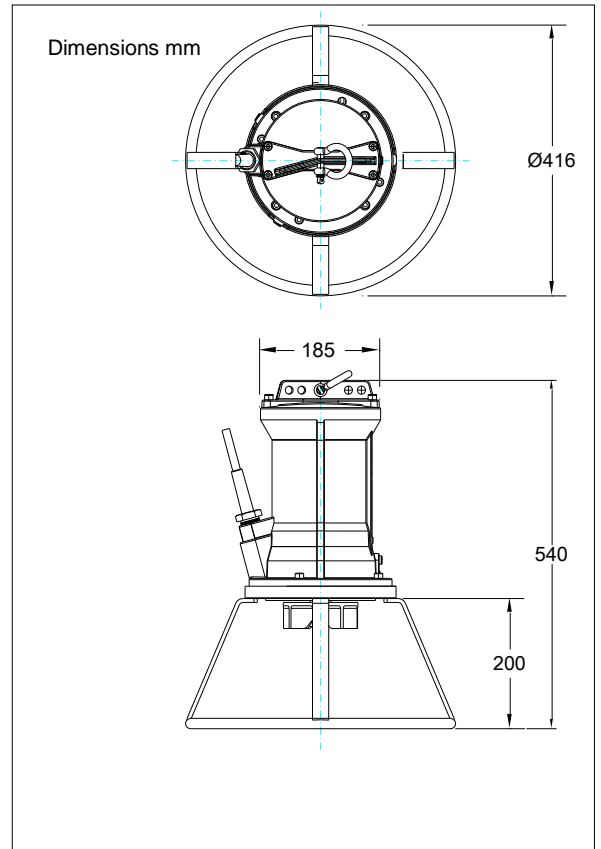

## Connections

voltage	current	electrical cable size		motor protection and/or water detector		flameproof version	
		direct start	star-delta start	direct start	star-delta start	direct start	star-delta start
230	8.7	4G1.5	7G1.5	7G1.5	10G1.5	7G1.5	10G1.5
400	5.0	4G1.5	7G1.5	7G1.5	10G1.5	7G1.5	10G1.5
500	4.0	4G1.5	7G1.5	7G1.5	10G1.5	7G1.5	10G1.5
starting current DOL start : 3.4 x rated current							
starting current YD start : 1.1 x rated current						* other voltages on request	

Type: Submersible mixer  
 Application: Prevent the accumulation of solids and floating crusts.

## Mixer

Effective area up to Ø10m  
 Impeller diameter 136mm  
 Electrical power in clean water 3.8 kW  
 Weight 47 kg

## Motor

Mains: 50Hz – 3 phase  
 Rated shaft power (P2) 3.5 kW  
 Absorbed electrical power (P1) 4.5 kW  
 Nominal speed 1385 rpm  
 Motor efficiency 78 %  
 Power factor (cos phi) 0.84  
 Degree of protection IP 68  
 Isolation class F (155°C)  
 Max. water temperature 40°C  
 Standard cable length 10 m



## Materials

Impeller AISI 329  
 Motor unit parts AISI 329  
 Pump shaft AISI 316  
 Pump support AISI 316  
 Bolts AISI 316  
 Rubber parts Viton (FPM)  
 Electrical cable Neoprene (CR)  
 Seal lubrication Oil  
 Seal pump side Silicon carbide – silicon carbide-Viton  
 Seal motor side Carbon - ceramic

## Optional

- Flameproof version, to class: II 2 G Ex d IIB c T4  
 Standard: II 2 G Ex b c d IIB T4 Gb  
 With Frequency control: II 2 G Ex b c d IIB T3 Gb
- Thermo switches in motor windings  
 (standard for flameproof version)
- Cable protection sheet (AISI316)
- Water detector in motor and oil chamber  
 Flameproof version with external cable
- Heavy duty support (AISI316)

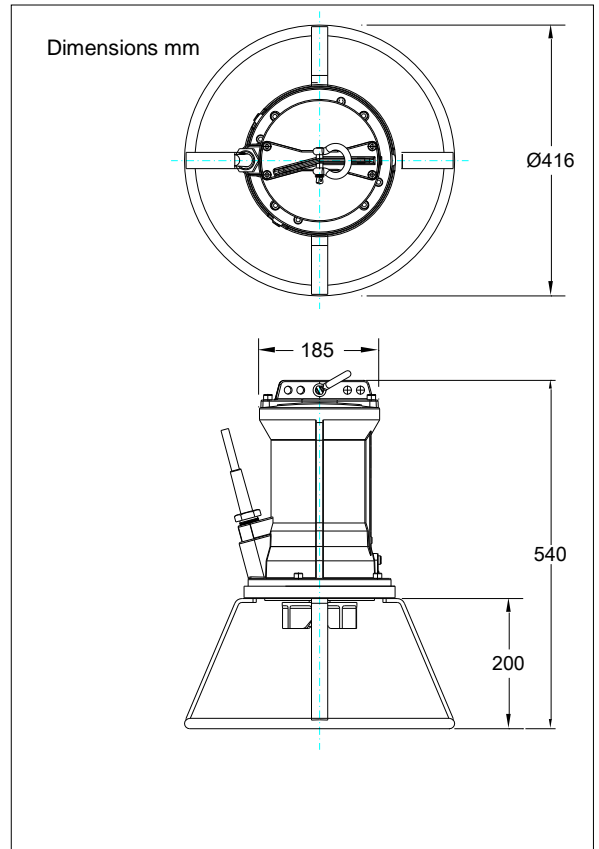

## Connections

voltage	current	electrical cable size		motor protection and/or water detector		flameproof version	
		direct start	star-delta start	direct start	star-delta start	direct start	star-delta start
230	13.4	4G1.5	7G1.5	7G1.5	10G1.5	7G1.5	10G1.5
400	7.7	4G1.5	7G1.5	7G1.5	10G1.5	7G1.5	10G1.5
500	6.2	4G1.5	7G1.5	7G1.5	10G1.5	7G1.5	10G1.5
starting current DOL start : 4.3 x rated current							
starting current YD start : 1.4 x rated current						* other voltages on request	

Type: Submersible mixer  
 Application: Prevent the accumulation of solids and floating crusts.

## Mixer

Effective area up to Ø12m  
 Impeller diameter 125  
 Electrical power in clean water 5.8 kW  
 Weight 85 kg

## Motor

Mains: 50Hz – 3 phase  
 Rated shaft power (P2) 5.0 kW  
 Absorbed electrical power (P1) 6.3 kW  
 Nominal speed 1420 rpm  
 Motor efficiency 79 %  
 Power factor (cos phi) 0.82  
 Degree of protection IP 68  
 Isolation class F (155°C)  
 Max. water temperature 40°C  
 Standard cable length 10 m

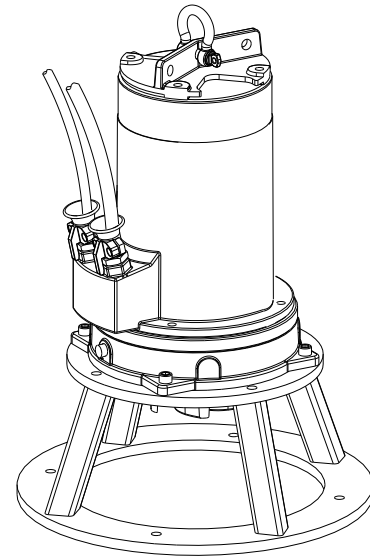

## Materials

Impeller AISI 329  
 Motor unit parts AISI 329  
 Pump shaft AISI 316  
 Pump support AISI 316  
 Bolts AISI 316  
 Rubber parts Viton (FPM)  
 Electrical cable Neoprene (CR)  
 Seal lubrication Oil  
 Seal pump side Silicon carbide – silicon carbide-Viton  
 Seal motor side Carbon - ceramic

## Optional

- Flameproof version, to class:  
 Standard: II 2 G Ex b c d IIB T4 Gb  
 With Frequency control: II 2 G Ex b c d IIB T3 Gb
- Thermoswitches in motor windings  
 (standard for flameproof version)
- Cable protection sheet (AISI316)
- Water detector in motor and oil chamber  
 Flameproof version with external cable

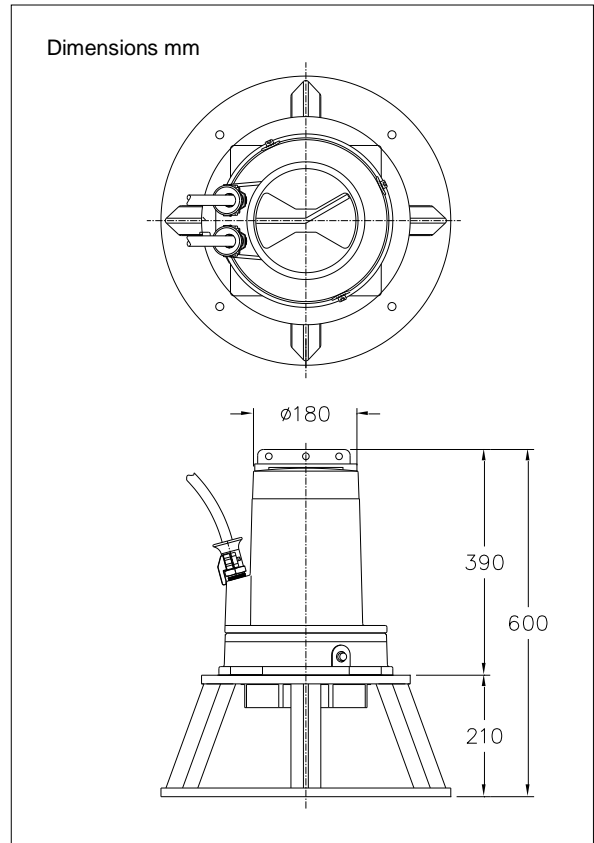

## Connections

voltage	current	electrical cable size		motor protection and/or water detector		flameproof version	
		directe start	ster-driehoek start	directe start	ster-driehoek start	directe start	ster-driehoek start
230	19.5	4G2.5	7G1.5	7G2.5	10G1.5	7G2.5	10G1.5
400	11.2	4G2.5	7G1.5	7G1.5	10G1.5	7G1.5	10G1.5
500	9.0	4G2.5	7G1.5	7G1.5	10G1.5	7G1.5	10G1.5
starting current DOL start : 5.0 x rated current							
starting current YD start : 1.7 x rated current						* other voltages on request	

Type: Submersible mixer  
 Application: Prevent the accumulation of solids and floating crusts.

## Mixer

Effective area up to Ø14m  
 Impeller diameter 150  
 Electrical power in clean water 7.1 kW  
 Weight 85 kg

## Motor

Mains: 50Hz – 3 phase  
 Rated shaft power (P2) 6.0 kW  
 Absorbed electrical power (P1) 7.7 kW  
 Nominal speed 1395 rpm  
 Motor efficiency 78 %  
 Power factor (cos phi) 0.85  
 Degree of protection IP 68  
 Isolation class F (155°C)  
 Max. water temperature 40°C  
 Standard cable length 10 m

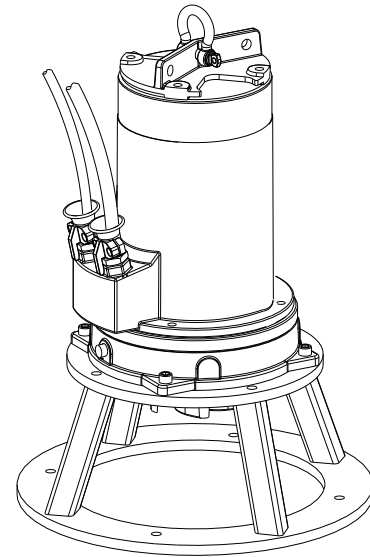

## Materials

Impeller AISI 329  
 Motor unit parts AISI 329  
 Pump shaft AISI 316  
 Pump support AISI 316  
 Bolts AISI 316  
 Rubber parts Viton (FPM)  
 Electrical cable Neoprene (CR)  
 Seal lubrication Oil  
 Seal pump side Silicon carbide – silicon carbide-Viton  
 Seal motor side Carbon - ceramic

## Optional

- Flameproof version, to class:  
 Standard: II 2 G Ex b c d IIB T4 Gb  
 With Frequency control: II 2 G Ex b c d IIB T3 Gb
- Thermoswitches in motor windings  
 (standard for flameproof version)
- Cable protection sheet (AISI316)
- Water detector in motor and oil chamber  
 Flameproof version with external cable

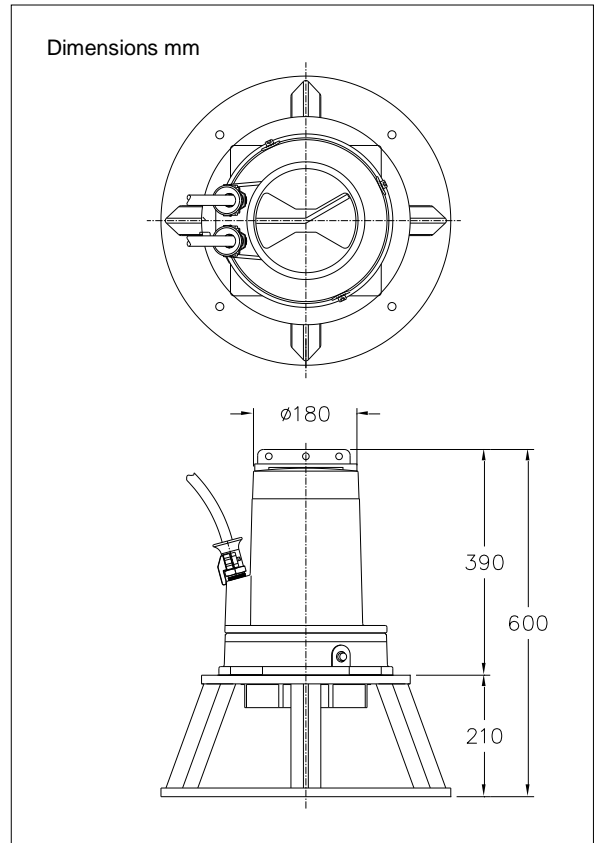

## Connections

voltage	current	electrical cable size		motor protection and/or water detector		flameproof version	
		directe start	ster-driehoek start	directe start	ster-driehoek start	directe start	ster-driehoek start
230	22.9	4G6	7G1.5	4G6 + 4G1.5	10G1.5	4G6 + 4G2.5	10G1.5
400	13.1	4G2.5	7G1.5	7G1.5	10G1.5	4G6 + 4G2.5	10G1.5
500	10.5	4G2.5	7G1.5	7G1.5	10G1.5	4G6 + 4G2.5	10G1.5
starting current DOL start : 4.2 x rated current							
starting current YD start : 1.4 x rated current						* other voltages on request	

Type: Submersible mixer  
 Application: Prevent the accumulation of solids and floating crusts.

## Mixer

Effective area up to Ø16m  
 Impeller diameter 160  
 Electrical power in clean water 8.6 kW  
 Weight 87 kg

## Motor

Mains: 50Hz – 3 phase  
 Rated shaft power (P2) 7.5 kW  
 Absorbed electrical power (P1) 9.3 kW  
 Nominal speed 1390 rpm  
 Motor efficiency 78 %  
 Power factor (cos phi) 0.88  
 Degree of protection IP 68  
 Isolation class F (155°C)  
 Max. water temperature 40°C  
 Standard cable length 10 m

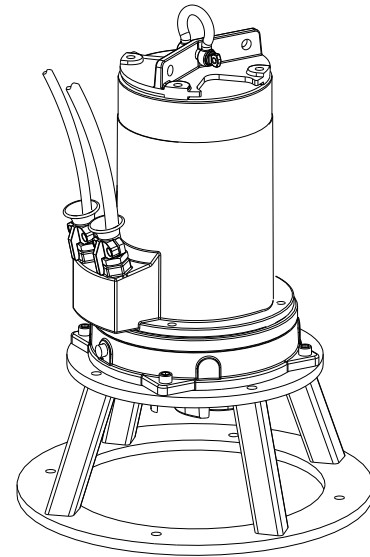

## Materials

Impeller AISI 329  
 Motor unit parts AISI 329  
 Pump shaft AISI 316  
 Pump support AISI 316  
 Bolts AISI 316  
 Rubber parts Viton (FPM)  
 Electrical cable Neoprene (CR)  
 Seal lubrication Oil  
 Seal pump side Silicon carbide – silicon carbide-Viton  
 Seal motor side Carbon - ceramic

## Optional

- Flameproof version, to class:  
 Standard: II 2 G Ex b c d IIB T4 Gb  
 With Frequency control: II 2 G Ex b c d IIB T3 Gb
- Thermoswitches in motor windings  
 (standard for flameproof version)
- Cable protection sheet (AISI316)
- Water detector in motor and oil chamber  
 Flameproof version with external cable

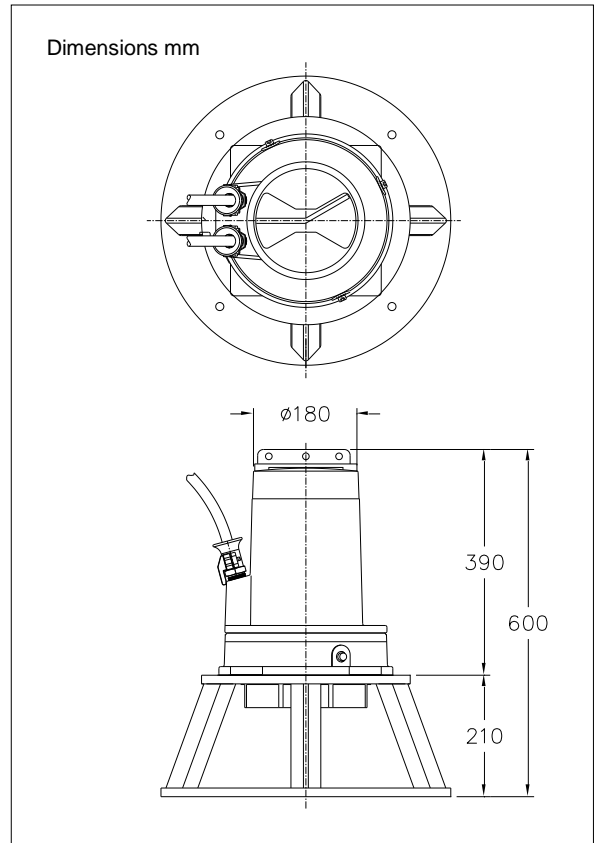

## Connections

voltage	current	electrical cable size		motor protection and/or water detector		flameproof version	
		directe start	ster-driehoek start	directe start	ster-driehoek start	directe start	ster-driehoek start
230	26.4	4G6	7G2.5	4G6 + 4G1.5	7G2.5 + 4G1.5	4G6 + 4G2.5	7G2.5 + 4G2.5
400	15.2	4G2.5	7G1.5	7G1.5	10G1.5	7G1.5	10G1.5
500	12.1	4G2.5	7G1.5	7G1.5	10G1.5	7G1.5	10G1.5
starting current DOL start : 6.1 x rated current							
starting current YD start : 2.0 x rated current						* other voltages on request	

Type: Submersible mixer  
 Application: Prevent the accumulation of solids and floating crusts.

## Mixer

Effective area up to Ø18m  
 Impeller diameter 230  
 Electrical power in clean water 13.5 kW  
 Weight 102 kg

## Motor

Mains: 50Hz – 3 phase  
 Rated shaft power (P2) 13.0 kW  
 Absorbed electrical power (P1) 15.1 kW  
 Nominal speed 1420 rpm  
 Motor efficiency 86 %  
 Power factor (cos phi) 0.84  
 Degree of protection IP 68  
 Isolation class F (155°C)  
 Max. water temperature 40°C  
 Standard cable length 10 m

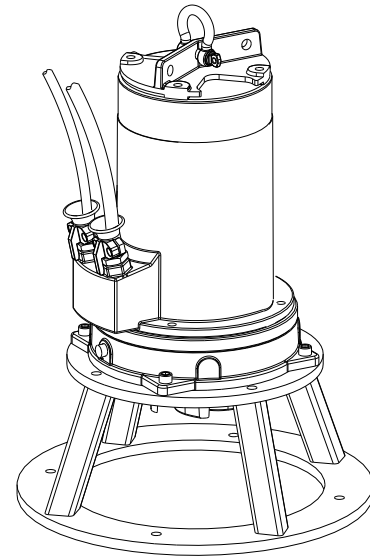

## Materials

Impeller AISI 329  
 Motor unit parts AISI 329  
 Pump shaft AISI 316  
 Pump support AISI 316  
 Bolts AISI 316  
 Rubber parts Viton (FPM)  
 Electrical cable Neoprene (CR)  
 Seal lubrication Oil  
 Seal pump side Silicon carbide – silicon carbide-Viton  
 Seal motor side Carbon - ceramic

## Optional

- Flameproof version, to class:  
 Standard: II 2 G Ex b c d IIB T4 Gb  
 With Frequency control: II 2 G Ex b c d IIB T3 Gb
- Thermoswitches in motor windings  
 (standard for flameproof version)
- Cable protection sheet (AISI316)
- Water detector in motor and oil chamber  
 Flameproof version with external cable

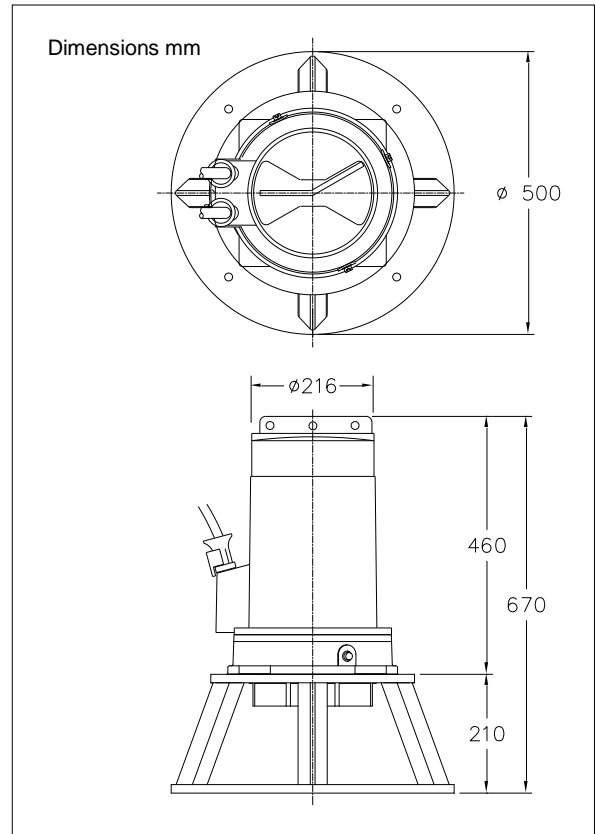

## Connections

voltage	current	electrical cable size		motor protection and/or water detector		flameproof version	
		directe start	ster-driehoek start	directe start	ster-driehoek start	directe start	ster-driehoek start
230	45.4	4G10	2x4G6	4G10 + 4G1.5	-	4G10 + 4G2.5	-
400	26.1	4G6	7G1.5	4G6 + 4G1.5	7G2.5 + 4G1.5	4G6 + 4G2.5	7G2.5 + 4G2.5
500	20.9	4G6	7G1.5	4G6 + 4G1.5	10G1.5	4G6 + 4G2.5	10G1.5
starting current DOL start : 5.0 x rated current							
starting current YD start : 1.7 x rated current						* other voltages on request	