

Type:	Submersible mixer
Application:	Prevent the accumulation of solids and floating crusts.

Mixer

Effective area	up to Ø6m
Impeller diameter	115mm
Electrical power in clean water	1.8 kW
Weight	44 kg

Motor

Mains:	50Hz – 3 phase
Rated shaft power (P2)	1.5 kW
Absorbed electrical power (P1)	2.1 kW
Nominal speed	1420 rpm
Motor efficiency	71 %
Power factor (cos phi)	0.84
Degree of protection	IP 68
Isolation class	F (155°C)
Max. water temperature	40°C
Standard cable length	10 m



Materials

Impeller	AISI 329
Motor unit parts	AISI 329
Pump shaft	AISI 316
Pump support	AISI 316
Bolts	AISI 316
Rubber parts	Viton (FPM)
Electrical cable	Neoprene (CR)
Seal lubrication	Oil
Seal pump side	Silicon carbide – silicon carbide-Viton
Seal motor side	Carbon - ceramic

Optional

- Flameproof version, to class: II 2 G Ex d IIB c T4
Standard: II 2 G Ex b c d IIB T4 Gb
With Frequency control: II 2 G Ex b c d IIB T3 Gb
- Thermo switches in motor windings (standard for flameproof version)
- Cable protection sheet (AISI316)
- Water detector in motor and oil chamber
Flameproof version with external cable
- Heavy duty support (AISI316)

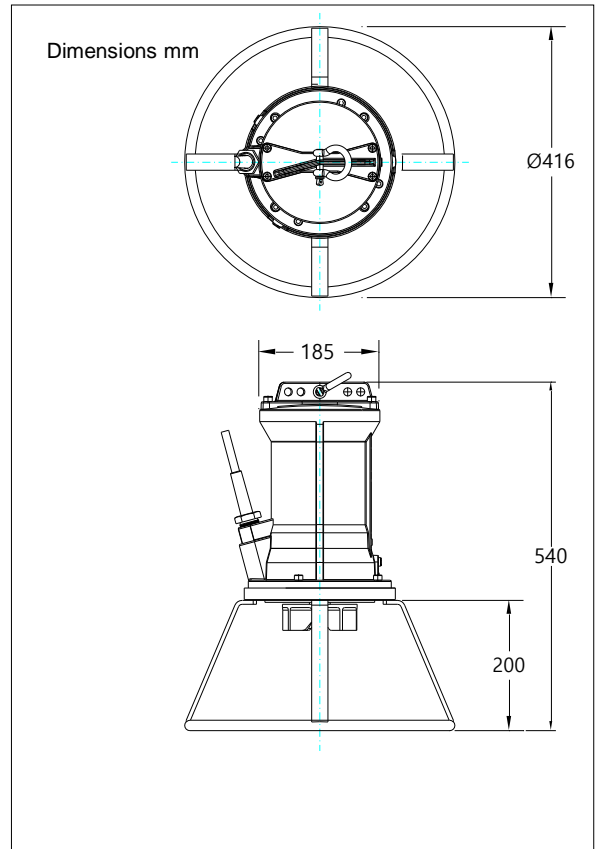

Connections

voltage	current	electrical cable size		motor protection and/or water detector		flameproof version		
		direct start		direct start		direct start		
230	6.3	4G1.5		7G1.5		7G1.5		
400	3.6	4G1.5		7G1.5		7G1.5		
500	2.9	4G1.5		7G1.5		7G1.5		
starting current DOL start : 4.8 x rated current								
							* other voltages on request	

Type: Submersible mixer
 Application: Prevent the accumulation of solids and floating crusts.

Mixer

Effective area up to Ø8m
 Impeller diameter 125mm
 Electrical power in clean water 2.5 kW
 Weight 44 kg

Motor

Mains: 50Hz – 3 phase
 Rated shaft power (P2) 2.2 kW
 Absorbed electrical power (P1) 3.1 kW
 Nominal speed 1375 rpm
 Motor efficiency 71 %
 Power factor (cos phi) 0.89
 Degree of protection IP 68
 Isolation class F (155°C)
 Max. water temperature 40°C
 Standard cable length 10 m



Materials

Impeller AISI 329
 Motor unit parts AISI 329
 Pump shaft AISI 316
 Pump support AISI 316
 Bolts AISI 316
 Rubber parts Viton (FPM)
 Electrical cable Neoprene (CR)
 Seal lubrication Oil
 Seal pump side Silicon carbide – silicon carbide-Viton
 Seal motor side Carbon - ceramic

Optional

- Flameproof version, to class: II 2 G Ex d IIB c T4
 Standard: II 2 G Ex b c d IIB T4 Gb
 With Frequency control: II 2 G Ex b c d IIB T3 Gb
- Thermo switches in motor windings (standard for flameproof version)
- Cable protection sheet (AISI316)
- Water detector in motor and oil chamber
 Flameproof version with external cable
- Heavy duty support (AISI316)

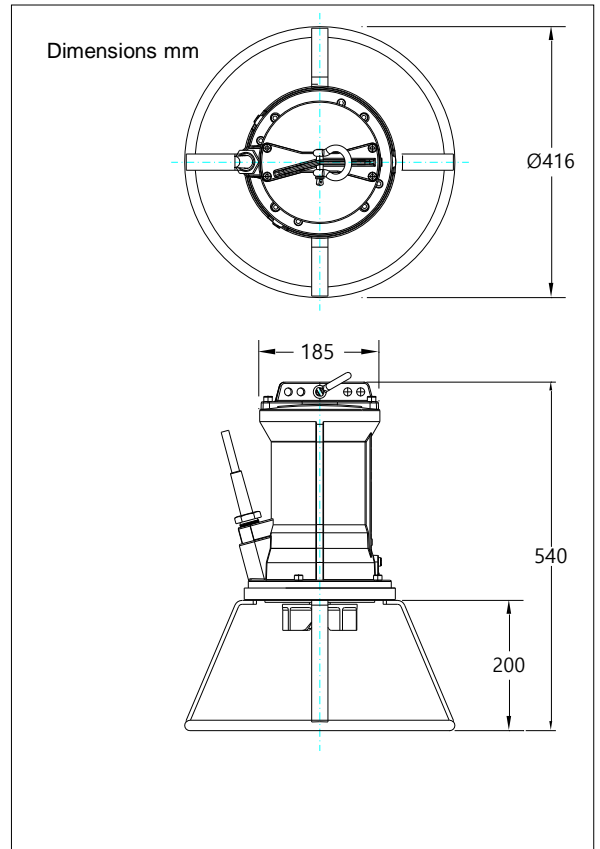

Connections

voltage	current	electrical cable size		motor protection and/or water detector		flameproof version	
		direct start	star-delta start	direct start	star-delta start	direct start	star-delta start
230	8.7	4G1.5	7G1.5	7G1.5	12G1.5	7G1.5	12G1.5
400	5.0	4G1.5	7G1.5	7G1.5	12G1.5	7G1.5	12G1.5
500	4.0	4G1.5	7G1.5	7G1.5	12G1.5	7G1.5	12G1.5
starting current DOL start : 3.4 x rated current							
starting current YD start : 1.1 x rated current						* other voltages on request	

Type: Submersible mixer
 Application: Prevent the accumulation of solids and floating crusts.

Mixer

Effective area up to Ø10m
 Impeller diameter 136mm
 Electrical power in clean water 3.8 kW
 Weight 47 kg

Motor

Mains: 50Hz – 3 phase
 Rated shaft power (P2) 3.5 kW
 Absorbed electrical power (P1) 4.5 kW
 Nominal speed 1385 rpm
 Motor efficiency 78 %
 Power factor (cos phi) 0.84
 Degree of protection IP 68
 Isolation class F (155°C)
 Max. water temperature 40°C
 Standard cable length 10 m



Materials

Impeller AISI 329
 Motor unit parts AISI 329
 Pump shaft AISI 316
 Pump support AISI 316
 Bolts AISI 316
 Rubber parts Viton (FPM)
 Electrical cable Neoprene (CR)
 Seal lubrication Oil
 Seal pump side Silicon carbide – silicon carbide-Viton
 Seal motor side Carbon - ceramic

Optional

- Flameproof version, to class: II 2 G Ex d IIB c T4
 Standard: II 2 G Ex b c d IIB T4 Gb
 With Frequency control: II 2 G Ex b c d IIB T3 Gb
- Thermo switches in motor windings (standard for flameproof version)
- Cable protection sheet (AISI316)
- Water detector in motor and oil chamber
 Flameproof version with external cable
- Heavy duty support (AISI316)

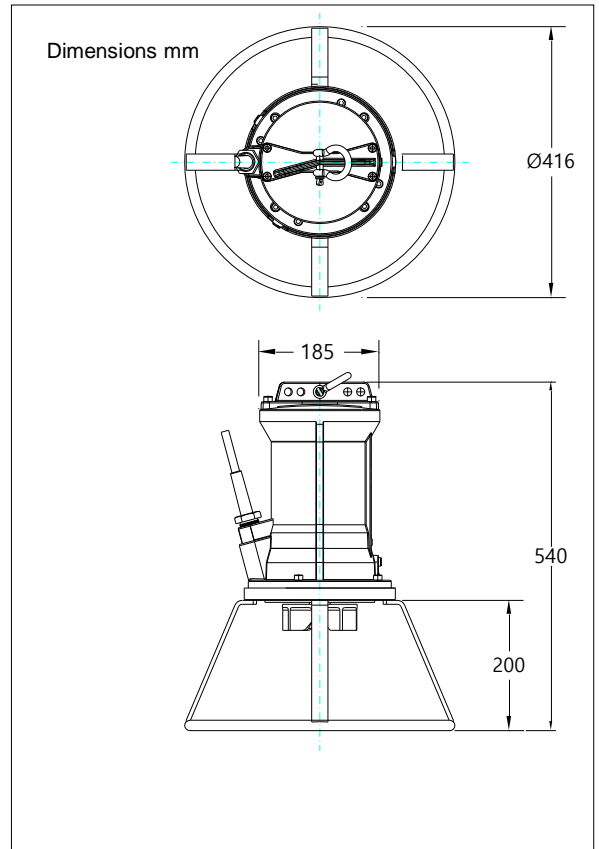

Connections

voltage	current	electrical cable size		motor protection and/or water detector		flameproof version	
		direct start	star-delta start	direct start	star-delta start	direct start	star-delta start
230	13.4	4G1.5	7G1.5	7G1.5	12G1.5	7G1.5	12G1.5
400	7.7	4G1.5	7G1.5	7G1.5	12G1.5	7G1.5	12G1.5
500	6.2	4G1.5	7G1.5	7G1.5	12G1.5	7G1.5	12G1.5
starting current DOL start : 4.3 x rated current							
starting current YD start : 1.4 x rated current						* other voltages on request	

Type:	Submersible mixer
Application:	Prevent the accumulation of solids and floating crusts.

Mixer

Effective area	up to Ø12m
Impeller diameter	125
Electrical power in clean water	5.8 kW
Weight	85 kg

Motor

Mains:	50Hz – 3 phase
Rated shaft power (P2)	5.0 kW
Absorbed electrical power (P1)	6.3 kW
Nominal speed	1420 rpm
Motor efficiency	79 %
Power factor (cos phi)	0.82
Degree of protection	IP 68
Isolation class	F (155°C)
Max. water temperature	40°C
Standard cable length	10 m

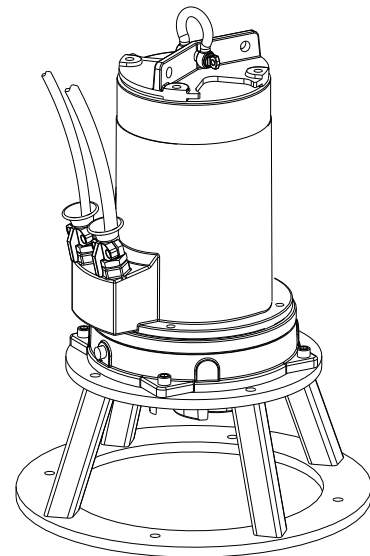

Materials

Impeller	AISI 329
Motor unit parts	AISI 329
Pump shaft	AISI 316
Pump support	AISI 316
Bolts	AISI 316
Rubber parts	Viton (FPM)
Electrical cable	Neoprene (CR)
Seal lubrication	Oil
Seal pump side	Silicon carbide – silicon carbide-Viton
Seal motor side	Carbon - ceramic

Optional

- Flameproof version, to class:
Standard: II 2 G Ex b c d IIB T4 Gb
With Frequency control: II 2 G Ex b c d IIB T3 Gb
- Thermoswitches in motor windings
(standard for flameproof version)
- Cable protection sheet (AISI316)
- Water detector in motor and oil chamber
Flameproof version with external cable

Dimensions mm

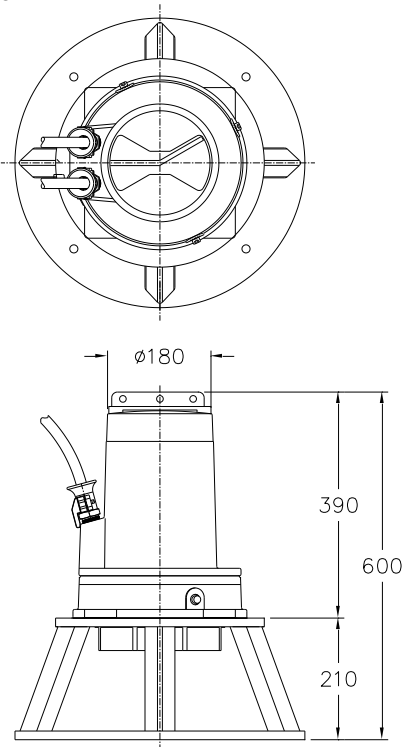

Connections

voltage	current	electrical cable size		motor protection and/or water detector		flameproof version	
		directe start	ster-driehoek start	directe start	ster-driehoek start	directe start	ster-driehoek start
230	19.5	4G2.5	7G1.5	7G2.5	12G1.5	7G2.5	12G1.5
400	11.2	4G2.5	7G1.5	7G1.5	12G1.5	7G1.5	12G1.5
500	9.0	4G2.5	7G1.5	7G1.5	12G1.5	7G1.5	12G1.5
starting current DOL start : 5.0 x rated current							
starting current YD start : 1.7 x rated current						* other voltages on request	

Type: Submersible mixer
 Application: Prevent the accumulation of solids and floating crusts.

Mixer

Effective area up to Ø14m
 Impeller diameter 150
 Electrical power in clean water 7.1 kW
 Weight 85 kg

Motor

Mains: 50Hz – 3 phase
 Rated shaft power (P2) 6.0 kW
 Absorbed electrical power (P1) 7.7 kW
 Nominal speed 1395 rpm
 Motor efficiency 78 %
 Power factor (cos phi) 0.85
 Degree of protection IP 68
 Isolation class F (155°C)
 Max. water temperature 40°C
 Standard cable length 10 m

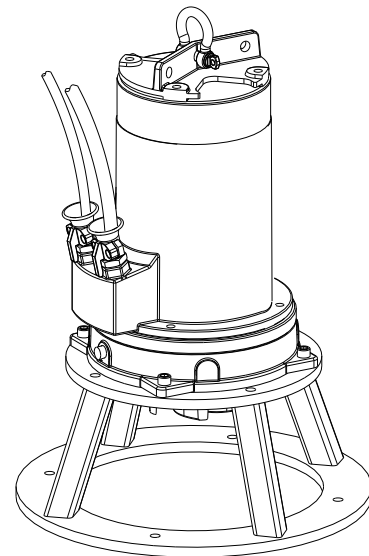

Materials

Impeller AISI 329
 Motor unit parts AISI 329
 Pump shaft AISI 316
 Pump support AISI 316
 Bolts AISI 316
 Rubber parts Viton (FPM)
 Electrical cable Neoprene (CR)
 Seal lubrication Oil
 Seal pump side Silicon carbide – silicon carbide-Viton
 Seal motor side Carbon - ceramic

Optional

- Flameproof version, to class:
 Standard: II 2 G Ex b c d IIB T4 Gb
 With Frequency control: II 2 G Ex b c d IIB T3 Gb
- Thermoswitches in motor windings
 (standard for flameproof version)
- Cable protection sheet (AISI316)
- Water detector in motor and oil chamber
 Flameproof version with external cable

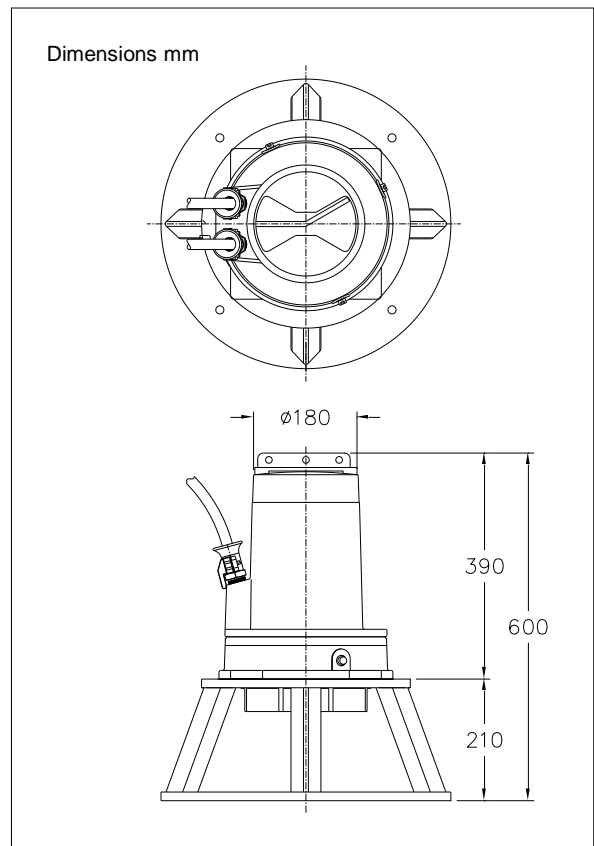

Connections

voltage	current	electrical cable size		motor protection and/or water detector		flameproof version	
		directe start	ster-driehoek start	directe start	ster-driehoek start	directe start	ster-driehoek start
230	22.9	4G6	7G1.5	4G6 + 4G1.5	12G1.5	4G6 + 4G2.5	12G1.5
400	13.1	4G2.5	7G1.5	7G1.5	12G1.5	4G6 + 4G2.5	12G1.5
500	10.5	4G2.5	7G1.5	7G1.5	12G1.5	4G6 + 4G2.5	12G1.5
starting current DOL start : 4.2 x rated current							
starting current YD start : 1.4 x rated current						* other voltages on request	

Type: Submersible mixer
 Application: Prevent the accumulation of solids and floating crusts.

Mixer

Effective area up to Ø16m
 Impeller diameter 160
 Electrical power in clean water 8.6 kW
 Weight 87 kg

Motor

Mains: 50Hz – 3 phase
 Rated shaft power (P2) 7.5 kW
 Absorbed electrical power (P1) 9.3 kW
 Nominal speed 1390 rpm
 Motor efficiency 78 %
 Power factor (cos phi) 0.88
 Degree of protection IP 68
 Isolation class F (155°C)
 Max. water temperature 40°C
 Standard cable length 10 m

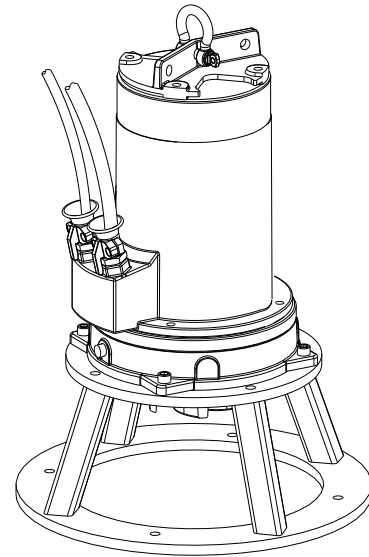

Materials

Impeller AISI 329
 Motor unit parts AISI 329
 Pump shaft AISI 316
 Pump support AISI 316
 Bolts AISI 316
 Rubber parts Viton (FPM)
 Electrical cable Neoprene (CR)
 Seal lubrication Oil
 Seal pump side Silicon carbide – silicon carbide-Viton
 Seal motor side Carbon - ceramic

Optional

- Flameproof version, to class:
 Standard: II 2 G Ex b c d IIB T4 Gb
 With Frequency control: II 2 G Ex b c d IIB T3 Gb
- Thermoswitches in motor windings
 (standard for flameproof version)
- Cable protection sheet (AISI316)
- Water detector in motor and oil chamber
 Flameproof version with external cable

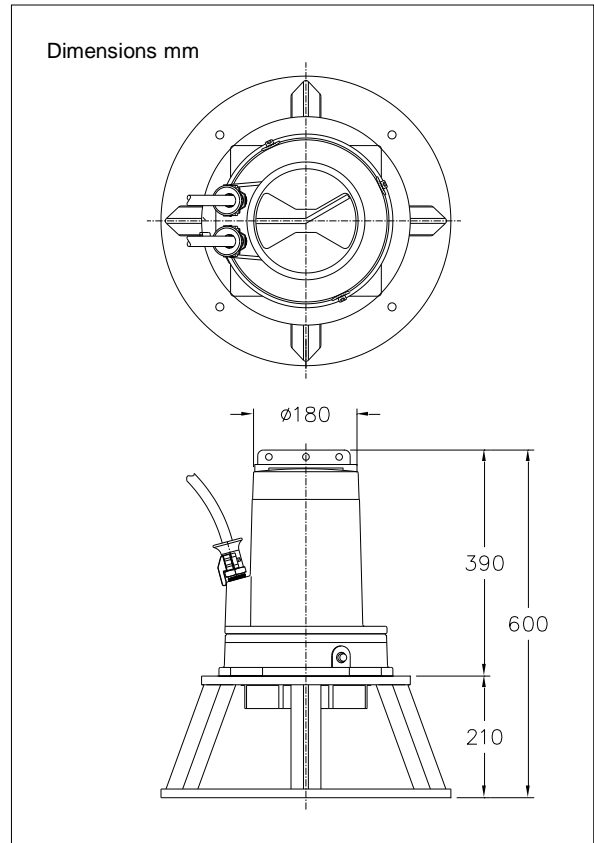

Connections

voltage	current	electrical cable size		motor protection and/or water detector		flameproof version	
		directe start	ster-driehoek start	directe start	ster-driehoek start	directe start	ster-driehoek start
230	26.4	4G6	7G2.5	4G6 + 4G1.5	7G2.5 + 4G1.5	4G6 + 4G2.5	7G2.5 + 4G2.5
400	15.2	4G2.5	7G1.5	7G1.5	12G1.5	7G1.5	12G1.5
500	12.1	4G2.5	7G1.5	7G1.5	12G1.5	7G1.5	12G1.5
starting current DOL start : 6.1 x rated current							
starting current YD start : 2.0 x rated current						* other voltages on request	

Type: Submersible mixer
 Application: Prevent the accumulation of solids and floating crusts.

Mixer

Effective area up to Ø18m
 Impeller diameter 230
 Electrical power in clean water 13.5 kW
 Weight 102 kg

Motor

Mains: 50Hz – 3 phase
 Rated shaft power (P2) 13.0 kW
 Absorbed electrical power (P1) 15.1 kW
 Nominal speed 1420 rpm
 Motor efficiency 86 %
 Power factor (cos phi) 0.84
 Degree of protection IP 68
 Isolation class F (155°C)
 Max. water temperature 40°C
 Standard cable length 10 m

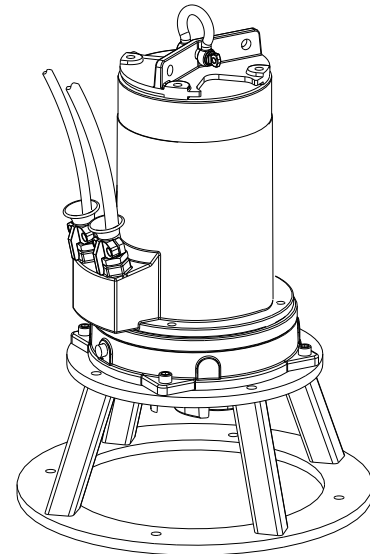

Materials

Impeller AISI 329
 Motor unit parts AISI 329
 Pump shaft AISI 316
 Pump support AISI 316
 Bolts AISI 316
 Rubber parts Viton (FPM)
 Electrical cable Neoprene (CR)
 Seal lubrication Oil
 Seal pump side Silicon carbide – silicon carbide-Viton
 Seal motor side Carbon - ceramic

Optional

- Flameproof version, to class:
 Standard: II 2 G Ex b c d IIB T4 Gb
 With Frequency control: II 2 G Ex b c d IIB T3 Gb
- Thermoswitches in motor windings (standard for flameproof version)
- Cable protection sheet (AISI316)
- Water detector in motor and oil chamber
 Flameproof version with external cable

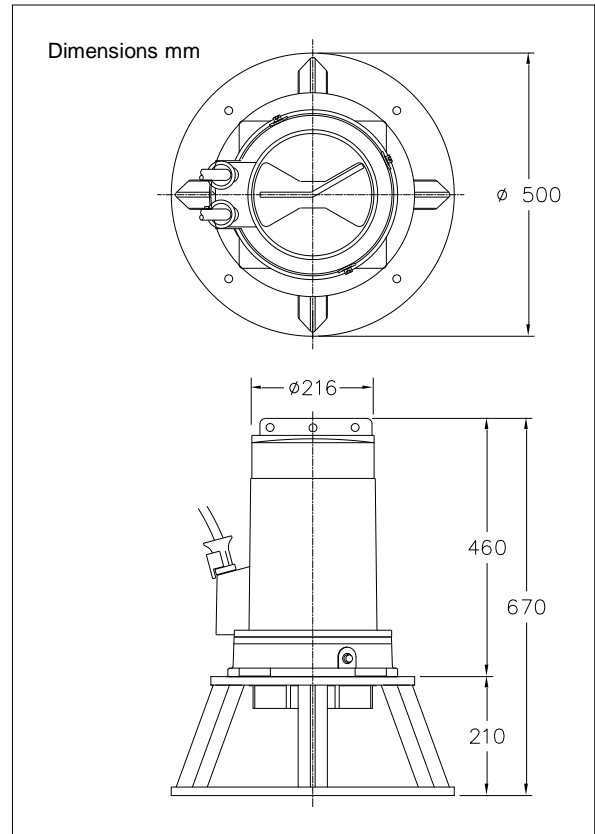

Connections

voltage	current	electrical cable size		motor protection and/or water detector		flameproof version	
		directe start	ster-driehoek start	directe start	ster-driehoek start	directe start	ster-driehoek start
230	45.4	4G10	2x4G6	4G10 + 4G1.5	-	4G10 + 4G2.5	-
400	26.1	4G6	7G1.5	4G6 + 4G1.5	7G2.5 + 4G1.5	4G6 + 4G2.5	7G2.5 + 4G2.5
500	20.9	4G6	7G1.5	4G6 + 4G1.5	12G1.5	4G6 + 4G2.5	12G1.5
starting current DOL start : 5.0 x rated current							
starting current YD start : 1.7 x rated current						* other voltages on request	