

Type: Submersible Duplex mixer  
 Application: Prevent the accumulation of solids and floating crusts.

**Mixer**

Effective area up to Ø6 m  
 Impeller diameter 105 mm  
 Electrical power in clean water 1.8 kW  
 Weight 43 kg

**Motor**

Mains: **60Hz – 3 phase**  
 Rated shaft power 1.75 kW  
 Rated electrical power 2.4 kW  
 Nominal speed 1700 rpm  
 Motor efficiency 71 %  
 Power factor (cos phi) 0.85  
 Degree of protection IP 68  
 Isolation class F (155°C)  
 Max. water temperature 40°C  
 Standard cable length 10 m

**Materials**

Impeller AISI 329  
 Motor unit parts AISI 329  
 Pump shaft AISI 316  
 Pump support AISI 316  
 Bolts AISI 316  
 Rubber parts Viton (FPM)  
 Electrical cable Neoprene (CR)  
 Seal lubrication Oil  
 Seal pump side Silicon carbide – silicon carbide-Viton  
 Seal motor side Carbon - ceramic

**Optional**

- Flameproof version, to class:  
 II 2 G Ex b c d IIB T4 Gb  
 With Frequency control: II 2 G Ex b c d IIB T3 Gb
- Thermo switches in motor windings  
 (standard for flameproof version)
- Cable protection sheet (AISI316)
- Water detector in motor and oil chamber  
 Flameproof version with external cable
- Heavy duty support (AISI316)

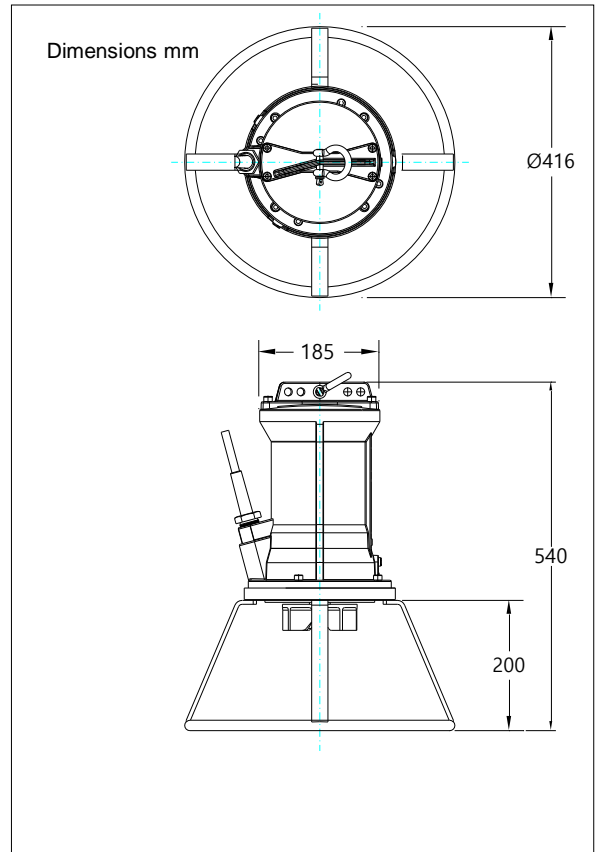

**Connections**

		electrical cable size		motor protection and/or water detector		flameproof version	
voltage	current						
[V]*	[A]	direct start		direct start		direct start	
220	7.5	4G1.5		7G1.5		7G1.5	
460	3.6	4G1.5		7G1.5		7G1.5	
575	2.9	4G1.5		7G1.5		7G1.5	
starting current DOL start : 4.8 x rated current							
							* other voltages on request

Type: Submersible Duplex mixer  
 Application: Prevent the accumulation of solids and floating crusts.

**Mixer**

Effective area up to Ø8 m  
 Impeller diameter 115 mm  
 Electrical power in clean water 3.1 kW  
 Weight 43 kg

**Motor**

Mains: 60Hz – 3 phase  
 Rated shaft power 2.5 kW  
 Rated electrical power 3.6 kW  
 Nominal speed 1650 rpm  
 Motor efficiency 71 %  
 Power factor (cos phi) 0.89  
 Degree of protection IP 68  
 Isolation class F (155°C)  
 Max. water temperature 40°C  
 Standard cable length 10 m



**Materials**

Impeller AISI 329  
 Motor unit parts AISI 329  
 Pump shaft AISI 316  
 Pump support AISI 316  
 Bolts AISI 316  
 Rubber parts Viton (FPM)  
 Electrical cable Neoprene (CR)  
 Seal lubrication Oil  
 Seal pump side Silicon carbide – silicon carbide-Viton  
 Seal motor side Carbon - ceramic

**Optional**

- Flameproof version, to class: II 2 G Ex b c d IIB T4 Gb  
 With Frequency control: II 2 G Ex b c d IIB T3 Gb
- Thermo switches in motor windings (standard for flameproof version)
- Cable protection sheet (AISI316)
- Water detector in motor and oil chamber  
 Flameproof version with external cable
- Heavy duty support (AISI316)

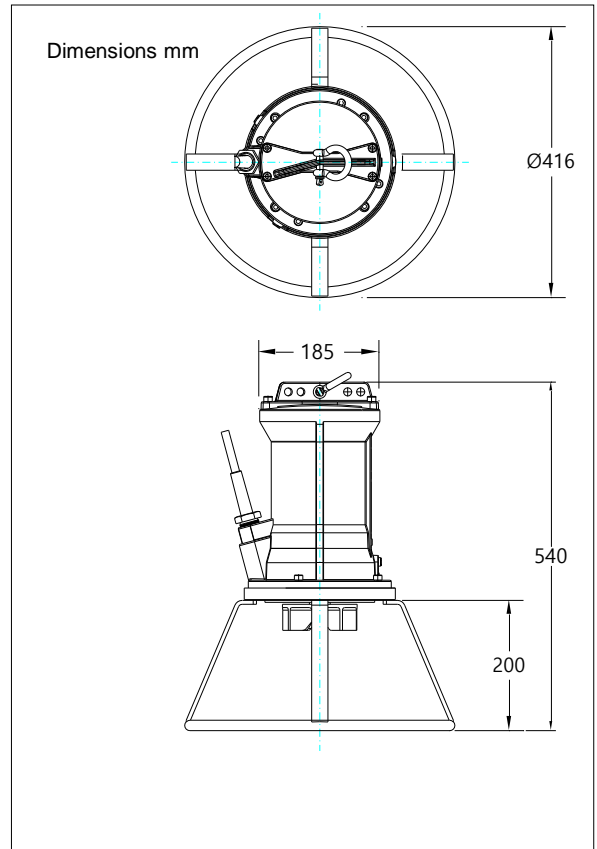

**Connections**

voltage	current	electrical cable size		motor protection and/or water detector		flameproof version	
		direct start	star-delta start	direct start	star-delta start	direct start	star-delta start
220	10.5	4G1.5	7G1.5	7G1.5	12G1.5	7G1.5	12G1.5
460	5.0	4G1.5	7G1.5	7G1.5	12G1.5	7G1.5	12G1.5
575	4.0	4G1.5	7G1.5	7G1.5	12G1.5	7G1.5	12G1.5
starting current DOL start : 3.4 x rated current							
starting current YD start : 1.1 x rated current						* other voltages on request	

Type: Submersible Duplex mixer  
 Application: Prevent the accumulation of solids and floating crusts.

**Mixer**

Effective area up to Ø10 m  
 Impeller diameter 125 mm  
 Electrical power in clean water 4.5 kW  
 Weight 47 kg

**Motor**

Mains: 60Hz – 3 phase  
 Rated shaft power 4.0 kW  
 Rated electrical power 5.2 kW  
 Nominal speed 1660 rpm  
 Motor efficiency 77 %  
 Power factor (cos phi) 0.85  
 Degree of protection IP 68  
 Isolation class F (155°C)  
 Max. water temperature 40°C  
 Standard cable length 10 m



**Materials**

Impeller AISI 329  
 Motor unit parts AISI 329  
 Pump shaft AISI 316  
 Pump support AISI 316  
 Bolts AISI 316  
 Rubber parts Viton (FPM)  
 Electrical cable Neoprene (CR)  
 Seal lubrication Oil  
 Seal pump side Silicon carbide – silicon carbide-Viton  
 Seal motor side Carbon - ceramic

**Optional**

- Flameproof version, to class: II 2 G Ex b c d IIB T4 Gb  
 With Frequency control: II 2 G Ex b c d IIB T3 Gb
- Thermo switches in motor windings (standard for flameproof version)
- Cable protection sheet (AISI316)
- Water detector in motor and oil chamber  
 Flameproof version with external cable
- Heavy duty support (AISI316)

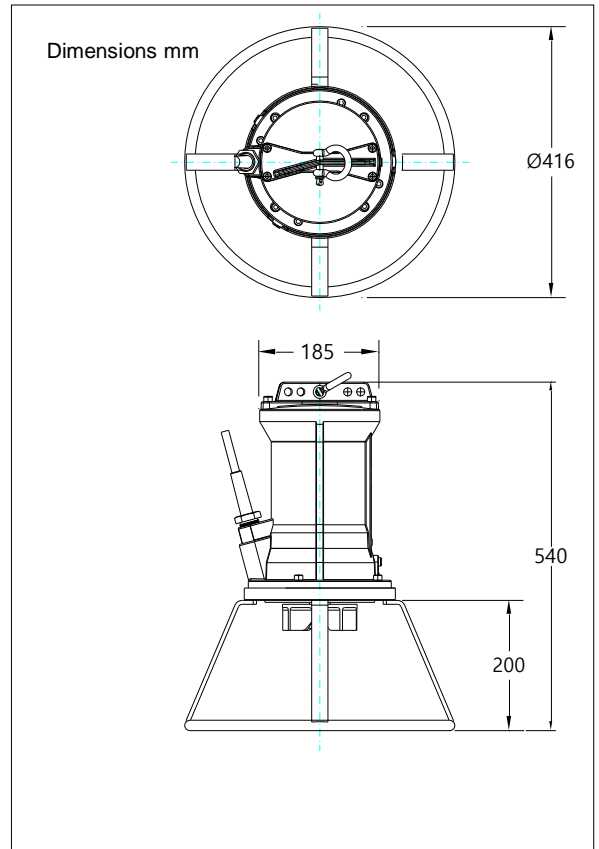

**Connections**

voltage	current	electrical cable size		motor protection and/or water detector		flameproof version	
		direct start	star-delta start	direct start	star-delta start	direct start	star-delta start
220	16.1	4G2.5	7G1.5	7G2.5	12G1.5	7G2.5	12G1.5
460	7.7	4G1.5	7G1.5	7G1.5	12G1.5	7G1.5	12G1.5
575	6.2	4G1.5	7G1.5	7G1.5	12G1.5	7G1.5	12G1.5
starting current DOL start : 4.3 x rated current							
starting current YD start : 1.4 x rated current						* other voltages on request	

Type: Submersible Duplex mixer  
 Application: Prevent the accumulation of solids and floating crusts.

**Mixer**

Effective area up to Ø14 m  
 Impeller diameter 135 mm  
 Electrical power in clean water 8.1 kW  
 Weight 85 kg

**Motor**

Mains: **60Hz** – 3 phase  
 Rated shaft power 6.9 kW  
 Rated electrical power 8.8 kW  
 Nominal speed 1674 rpm  
 Motor efficiency 78 %  
 Power factor (cos phi) 0.85  
 Degree of protection IP 68  
 Isolation class F (155°C)  
 Max. water temperature 40°C  
 Standard cable length 10 m

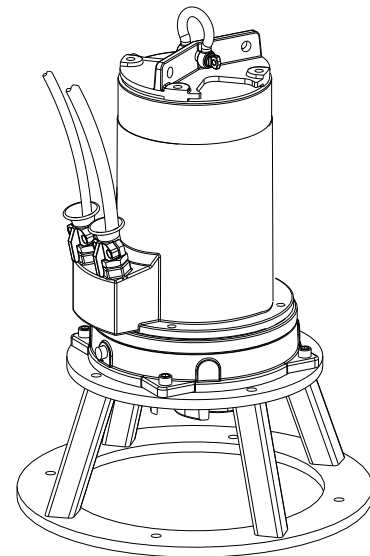

**Materials**

Impeller AISI 329  
 Motor unit parts AISI 329  
 Pump shaft AISI 316  
 Pump support AISI 316  
 Bolts AISI 316  
 Rubber parts Viton (FPM)  
 Electrical cable Neoprene (CR)  
 Seal lubrication Oil  
 Seal pump side Silicon carbide – silicon carbide-Viton  
 Seal motor side Carbon - ceramic

**Optional**

- Flameproof version, to class: II 2 G Ex b c d IIB T4 Gb  
 With Frequency control: II 2 G Ex b c d IIB T3 Gb
- Thermoswitches in motor windings (standard for flameproof version)
- Cable protection sheet (AISI316)
- Water detector in motor and oil chamber  
 Flameproof version with external cable

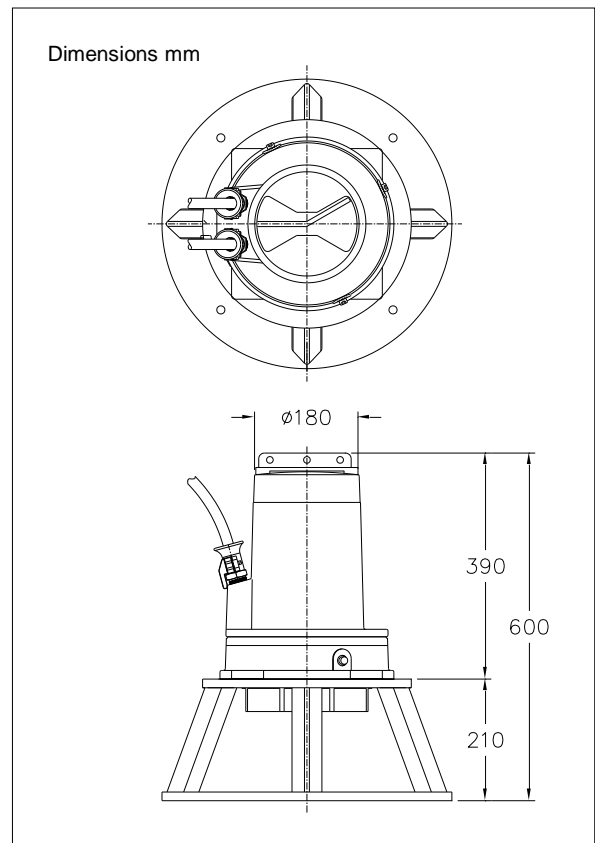

**Connections**

voltage	current	electrical cable size		motor protection and/or water detector		flameproof version	
		directe start	ster-driehoek start	directe start	ster-driehoek start	directe start	ster-driehoek start
220	27.3	4G6	7G1.5	4G6 + 4G1.5	12G1.5	4G6 + 4G2.5	12G1.5
460	13.1	4G2.5	7G1.5	7G1.5	12G1.5	7G1.5	12G1.5
575	10.5	4G2.5	7G1.5	7G1.5	12G1.5	7G1.5	12G1.5
starting current DOL start : 4.2 x rated current							
starting current YD start : 1.5 x rated current						* other voltages on request	

Type: Submersible Duplex mixer  
 Application: Prevent the accumulation of solids and floating crusts.

**Mixer**

Effective area up to Ø16 m  
 Impeller diameter 140 mm  
 Electrical power in clean water 9.9 kW  
 Weight 87 kg

**Motor**

Mains: **60Hz** – 3 phase  
 Rated shaft power 8.6 kW  
 Rated electrical power 10.6 kW  
 Nominal speed 1668 rpm  
 Motor efficiency 81 %  
 Power factor (cos phi) 0.87  
 Degree of protection IP 68  
 Isolation class F (155°C)  
 Max. water temperature 40°C  
 Standard cable length 10 m

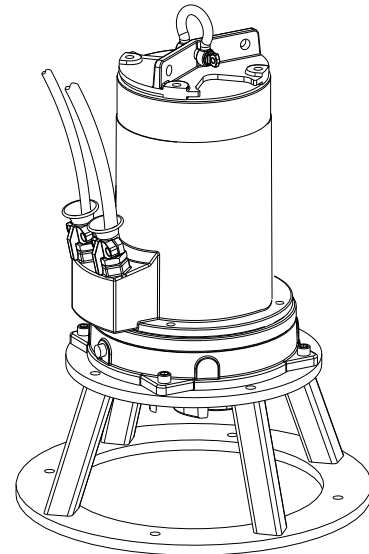

**Materials**

Impeller AISI 329  
 Motor unit parts AISI 329  
 Pump shaft AISI 316  
 Pump support AISI 316  
 Bolts AISI 316  
 Rubber parts Viton (FPM)  
 Electrical cable Neoprene (CR)  
 Seal lubrication Oil  
 Seal pump side Silicon carbide – silicon carbide-Viton  
 Seal motor side Carbon - ceramic

**Optional**

- Flameproof version, to class: II 2 G Ex b c d IIB T4 Gb  
 With Frequency control: II 2 G Ex b c d IIB T3 Gb
- Thermoswitches in motor windings (standard for flameproof version)
- Cable protection sheet (AISI316)
- Water detector in motor and oil chamber  
 Flameproof version with external cable

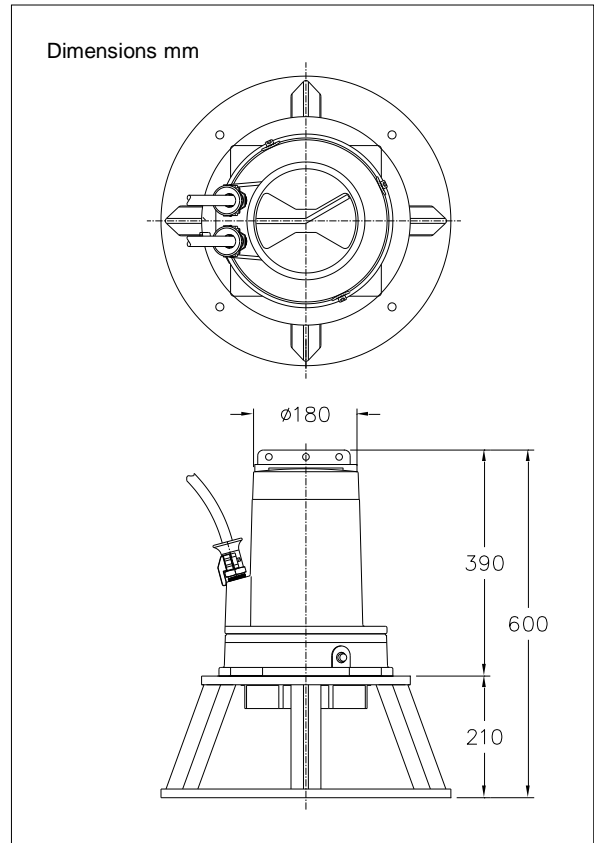

**Connections**

voltage	current	electrical cable size		motor protection and/or water detector		flameproof version	
		directe start	ster-driehoek start	directe start	ster-driehoek start	directe start	ster-driehoek start
220	32.1	4G6	7G2.5	4G6 + 4G1.5	7G2.5 + 4G1.5	4G6 + 4G2.5	7G2.5 + 4G2.5
460	15.4	4G2.5	7G1.5	7G1.5	12G1.5	7G1.5	12G1.5
575	12.3	4G2.5	7G1.5	7G1.5	12G1.5	7G1.5	12G1.5
starting current DOL start : 6.1 x rated current							
starting current YD start : 2.0 x rated current						* other voltages on request	

Type: Submersible Duplex mixer  
 Application: Prevent the accumulation of solids and floating crusts.

**Mixer**

Effective area up to Ø18 m  
 Impeller diameter 155 mm  
 Electrical power in clean water 15.5 kW  
 Weight 102 kg

**Motor**

Mains: **60Hz** – 3 phase  
 Rated shaft power 14.9 kW  
 Rated electrical power 17.5 kW  
 Nominal speed 1704 rpm  
 Motor efficiency 85 %  
 Power factor (cos phi) 0.84  
 Degree of protection IP 68  
 Isolation class F (155°C)  
 Max. water temperature 40°C  
 Standard cable length 10 m

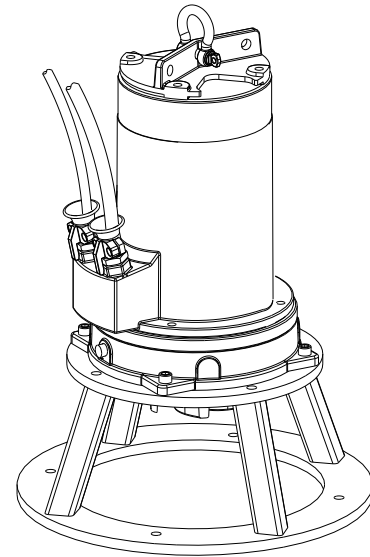

**Materials**

Impeller AISI 329  
 Motor unit parts AISI 329  
 Pump shaft AISI 316  
 Pump support AISI 316  
 Bolts AISI 316  
 Rubber parts Viton (FPM)  
 Electrical cable Neoprene (CR)  
 Seal lubrication Oil  
 Seal pump side Silicon carbide – silicon carbide-Viton  
 Seal motor side Carbon - ceramic

**Optional**

- Flameproof version, to class:  
 II 2 G Ex b c d IIB T4 Gb  
 With Frequency control: II 2 G Ex b c d IIB T3 Gb
- Thermoswitches in motor windings  
 (standard for flameproof version)
- Cable protection sheet (AISI316)
- Water detector in motor and oil chamber  
 Flameproof version with external cable

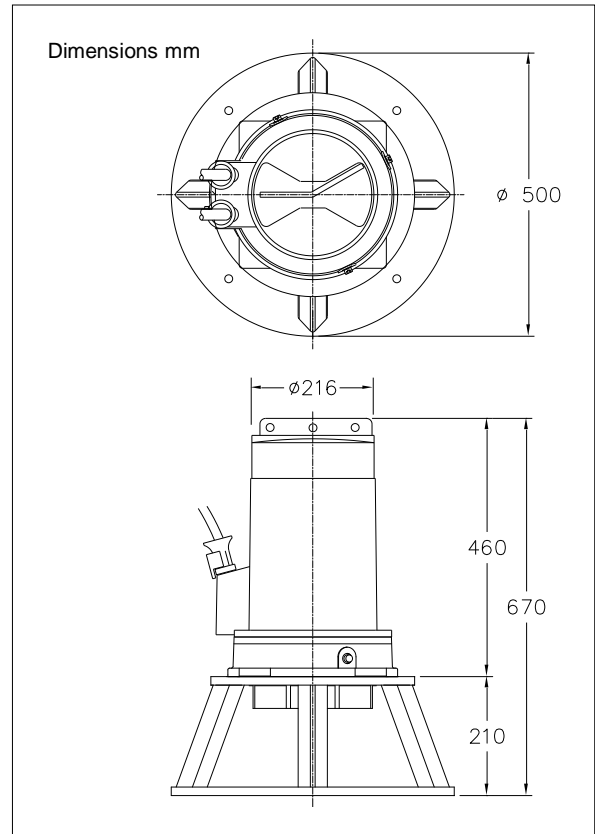

**Connections**

voltage	current	electrical cable size		motor protection and/or water detector		flameproof version	
		directe start	ster-driehoek start	directe start	ster-driehoek start	directe start	ster-driehoek start
220	55.0	2x 4G6	2x 4G6	-	-	-	-
460	26.3	4G6	7G2.5	4G6 + 4G1.5	7G2.5 + 4G1.5	4G6 + 4G2.5	7G2.5 + 4G2.5
575	21.0	4G2.5	7G1.5	7G2.5	12G1.5	7G2.5	12G1.5
starting current DOL start : 5.0 x rated current							
starting current YD start : 1.7 x rated current				* other voltages on request			