

Type: Submersible Duplex mixer  
 Application: Preventing the accumulation of solids and floating crusts.

**Technical data**

Effective area up to Ø 20 ft  
 Impeller code 105  
 Electrical power in clean water 1.9 kW  
 Weight 95 lbs

**Motor**

Mains: 60 c/s – 3 phase  
 Rated horse power 2.3 HP  
 Rated electrical power 2.4 kW  
 Rated kVA 2.9 kVA  
 Nominal speed 1700 rpm  
 Motor efficiency 71 %  
 Power factor (cos phi) 0.85  
 Degree of protection IP 68  
 Isolation class F (311°F)  
 Max. water temperature 104°F  
 Standard cable length 66 ft



**Materials**

Impeller S.g cast iron (ASTM A-445 Gr.60-46-18)  
 Motor unit Cast iron (ASTM A-48 class 35)  
 Shaft AISI 316  
 Bolts AISI 316  
 Support AISI 316  
 Elastomers Viton (FPM)  
 Electrical cable Neoprene (CR)  
 Seal lubrication Oil  
 Seal pump side Silicon carbide – silicon carbide - FPM  
 Seal motor side Carbon - Ceramic

**Optional**

- Thermo switches in stator windings
- Cable protective sheathing (AISI 316)
- Water detector in motor and oil chamber
- Heavy duty support

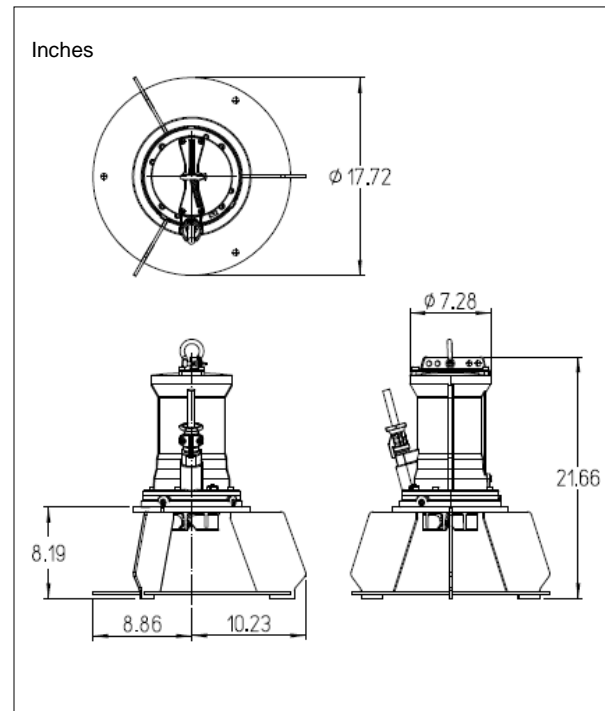

**Connections**

voltage	current	electrical cable size	
		direct start	with motor protection and/or water detector
[V]*	[A]	direct start	direct start
208	7.9	AWG 14/4	AWG 14/7
230	7.2	AWG 14/4	AWG 14/7
460	3.6	AWG 14/4	AWG 14/7
575	2.9	AWG 14/4	AWG 14/7
starting current DOL start : 4.8 x rated current			
* other voltages on request			

Type: Submersible Duplex mixer  
 Application: Preventing the accumulation of solids and floating crusts.

**Technical data**

Effective area up to Ø 24 ft  
 Impeller code 115  
 Electrical power in clean water 3.1 kW  
 Weight 95 lbs

**Motor**

Mains: 60 c/s – 3 phase  
 Rated horse power 3.4 HP  
 Rated electrical power 3.6 kW  
 Rated kVA 4.0 kVA  
 Nominal speed 1650 rpm  
 Motor efficiency 71 %  
 Power factor (cos phi) 0.89  
 Degree of protection IP 68  
 Isolation class F (311°F)  
 Max. water temperature 104°F  
 Standard cable length 66 ft



**Materials**

Impeller S.g cast iron (ASTM A-445 Gr.60-46-18)  
 Motor unit Cast iron (ASTM A-48 class 35)  
 Shaft AISI 316  
 Bolts AISI 316  
 Support AISI 316  
 Elastomers Viton (FPM)  
 Electrical cable Neoprene (CR)  
 Seal lubrication Oil  
 Seal pump side Silicon carbide – silicon carbide - Viton  
 Seal motor side Carbon - Ceramic

**Options available**

- Thermo switches in stator windings
- Cable protective sheathing (AISI 316)
- Water detector in motor and oil chamber
- Heavy duty support

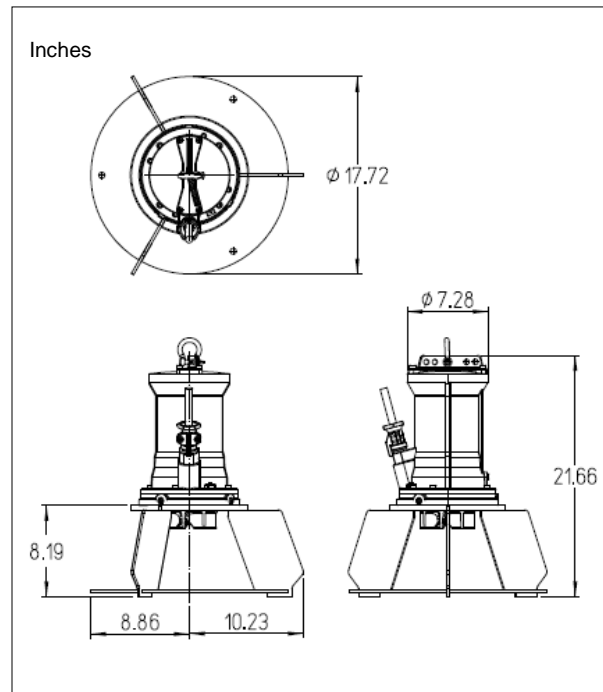

**Connections**

voltage	current	electrical cable size			
		direct start		with motor protection and/or water detector	
[V]*	[A]	direct start	star delta start	direct start	star delta start
208	11.1	AWG 14/4	AWG 14/7	AWG 14/7	-
230	10.1	AWG 14/4	AWG 14/7	AWG 14/7	-
460	5.0	AWG 14/4	AWG 14/7	AWG 14/7	-
575	4.0	AWG 14/4	AWG 14/7	AWG 14/7	-
starting current DOL start : 3.4 x rated current					
starting current YD start : 1.1 x rated current					

\* other voltages on request

Type: Submersible Duplex mixer  
 Application: Preventing the accumulation of solids and floating crusts.

**Technical data**

Effective area up to Ø 30 ft  
 Impeller code 125  
 Electrical power in clean water 4.5 kW  
 Weight 101 lbs

**Motor**

Mains: 60 c/s – 3 phase  
 Rated horse power 5.4 HP  
 Rated electrical power 5.2 kW  
 Rated kVA 6.1 kVA  
 Nominal speed 1660 rpm  
 Motor efficiency 77 %  
 Power factor (cos phi) 0.85  
 Degree of protection IP 68  
 Isolation class F (311°F)  
 Max. water temperature 104°F  
 Standard cable length 66 ft



**Materials**

Impeller AISI 329  
 Motor unit AISI 329  
 Shaft AISI 316  
 Bolts AISI 316  
 Support AISI 316  
 Elastomers Viton (FPM)  
 Electrical cable Neoprene (CR)  
 Seal lubrication Oil  
 Seal pump side Silicon carbide – silicon carbide - FPM  
 Seal motor side Carbon - Ceramic

**Options available**

- Thermo switches in stator windings
- Cable protective sheathing (AISI 316)
- Water detector in motor and oil chamber
- Heavy duty support

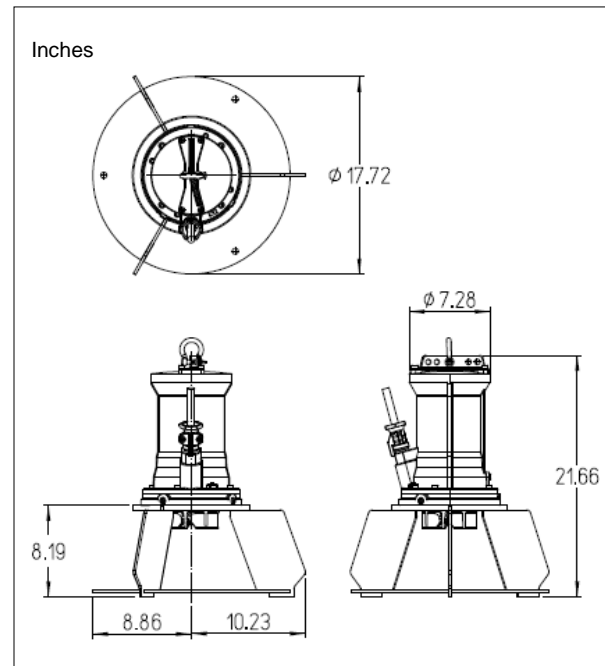

**Connections**

		electrical cable size					
voltage	current			with motor protection and/or water detector			
[V]*	[A]	direct start	star delta start	direct start	star delta start		
208	17.1	AWG 10/4	AWG 14/7	-	-		
230	15.4	AWG 10/4	AWG 14/7	-	-		
460	7.7	AWG 14/4	AWG 14/7	AWG 14/7	-		
575	6.2	AWG 14/4	AWG 14/7	AWG 14/7	-		
starting current DOL start : 4.3 x rated current							
starting current YD start : 1.4 x rated current				* other voltages on request			

Type: Submersible Duplex mixer  
 Application: Preventing the accumulation of solids and floating crusts.

**Mixer**

Effective area up to Ø 46 ft  
 Impeller code 135  
 Electrical power in clean water 8.1 kW  
 Weight 187 lbs

**Motor**

Mains: 60c/s – 3 phase  
 Rated horse power 9.2 HP  
 Rated electrical power 8.8 kW  
 Rated kVA 10.4 kVA  
 Nominal speed 1674 rpm  
 Motor efficiency 78 %  
 Power factor (cos phi) 0.85  
 Degree of protection IP 68  
 Isolation class F (311°F)  
 Max. water temperature 104°F  
 Standard cable length 33 ft



**Materials**

Impeller AISI 329  
 Motor unit parts AISI 329  
 Pump shaft AISI 316  
 Pump support AISI 316  
 Bolts AISI 316  
 Elastomers Viton (FPM)  
 Electrical cable Neoprene (CR)  
 Seal lubrication Oil  
 Seal pump side Silicon carbide – silicon carbide-FPM  
 Seal motor side Carbon - ceramic

**Optional**

- Thermo switches in motor windings
- Cable protection sheet (AISI316)
- Water detector in motor and oil chamber

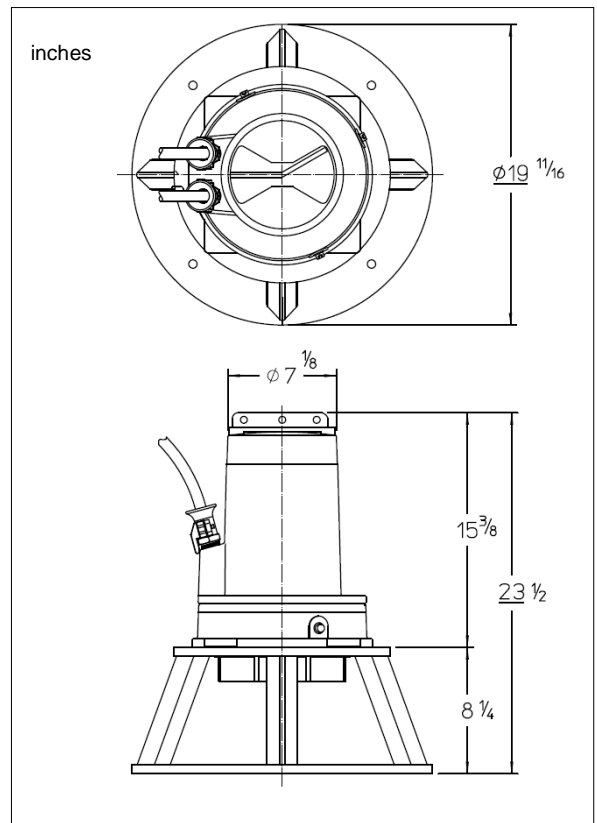

**Connections**

		electrical cable size		motor protection and/or water detector	
voltage	current				
[V]*	[A]	directe start	ster-driehoek start	directe start	ster-driehoek start
208	28.9	AWG 8/4	2x AWG 10/4	AWG 8/4 + AWG 14/4	-
230	26.1	AWG 8/4	2x AWG 10/4	AWG 8/4 + AWG 14/4	-
460	13.1	AWG 14/4	AWG 14/7	AWG 14/7	-
575	10.5	AWG 14/4	AWG 14/7	AWG 14/7	-
starting current DOL start : 4.2 x rated current					
starting current YD start : 1.4 x rated current				* other voltages on request	

Type: Submersible Duplex mixer  
 Application: Preventing the accumulation of solids and floating crusts.

**Mixer**

Effective area up to Ø 53 ft  
 Impeller code 140  
 Electrical power in clean water 9.9 kW  
 Weight 192 lbs

**Motor**

Mains: 60 c/s – 3 phase  
 Rated horse power 11.6 HP  
 Rated electrical power 10.6 kW  
 Rated kVA 12.2 kVA  
 Nominal speed 1668 rpm  
 Motor efficiency 81 %  
 Power factor (cos phi) 0.87  
 Degree of protection IP 68  
 Isolation class F (311°F)  
 Max. water temperature 104°F  
 Standard cable length 33 ft



**Materials**

Impeller AISI 329  
 Motor unit parts AISI 329  
 Pump shaft AISI 316  
 Pump support AISI 316  
 Bolts AISI 316  
 Elastomers Viton (FPM)  
 Electrical cable Neoprene (CR)  
 Seal lubrication Oil  
 Seal pump side Silicon carbide – silicon carbide - FPM  
 Seal motor side Carbon - ceramic

**Optional**

- Thermo switches in motor windings
- Cable protection sheet (AISI316)
- Water detector in motor and oil chamber

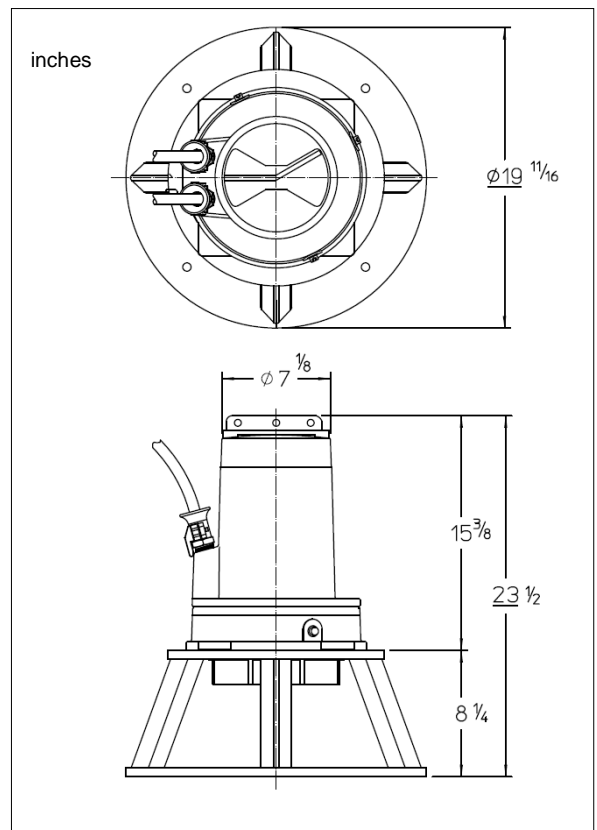

**Connections**

		electrical cable size					
voltage	current			with motor protection and/or water detector			
[V]*	[A]	direct start	star delta start	direct start	star delta start		
208	34.0	AWG 8/4	2x AWG 10/4	AWG 8/4 + AWG 14/4	-		
230	30.7	AWG 8/4	2x AWG 10/4	AWG 8/4 + AWG 14/4	-		
460	15.4	AWG 10/4	AWG 14/7	AWG 10/4 + AWG 14/4	AWG 14/7+ AWG 14/4		
575	12.3	AWG 14/4	AWG 14/7	AWG 14/7	AWG 14/7+ AWG 14/4		
starting current DOL start : 6.1 x rated current							
starting current YD start : 2.0 x rated current						* other voltages on request	

Type: Submersible Duplex mixer  
 Application: Preventing the accumulation of solids and floating crusts.

**Mixer**

Effective area up to Ø 60 ft  
 Impeller code 155  
 Electrical power in clean water 15.5 kW  
 Weight 225 lbs

**Motor**

Mains: 60 c/s – 3 phase  
 Rated horse power 20.0 HP  
 Rated electrical power 17.5 kW  
 Rated kVA 20.9 kVA  
 Nominal speed 1704 rpm  
 Motor efficiency 85 %  
 Power factor (cos phi) 0.84  
 Degree of protection IP 68  
 Isolation class F (311°F)  
 Max. water temperature 104°F  
 Standard cable length 33 ft



**Materials**

Impeller AISI 329  
 Motor unit parts AISI 329  
 Pump shaft AISI 316  
 Pump support AISI 316  
 Bolts AISI 316  
 Elastomers Viton (FPM)  
 Electrical cable Neoprene (CR)  
 Seal lubrication Oil  
 Seal pump side Silicon carbide – silicon carbide - FPM  
 Seal motor side Carbon - ceramic

**Optional**

- Thermo switches in motor windings
- Cable protection sheet (AISI316)
- Water detector in motor and oil chamber

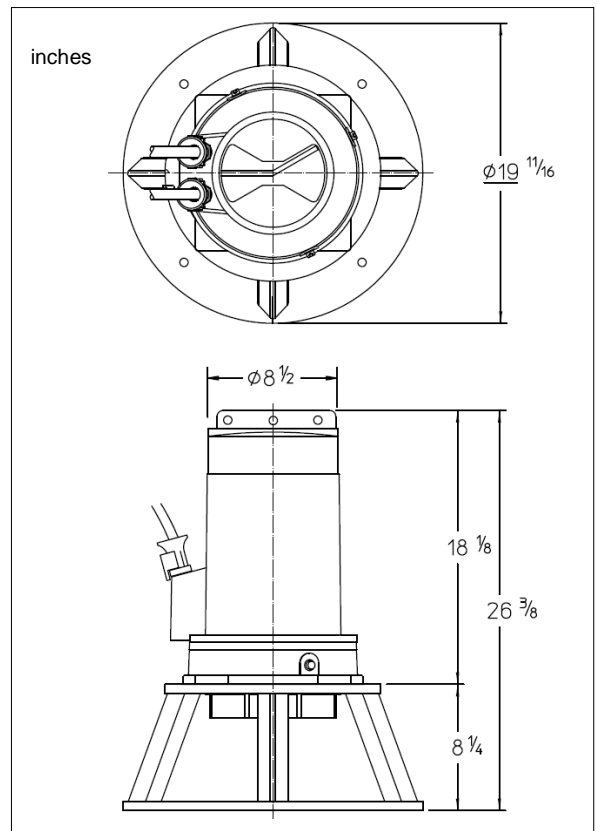

**Connections**

		electrical cable size					
voltage	current			with motor protection and/or water detector			
[V]*	[A]	direct start	star delta start	direct start	star delta start		
208	58.1	2x AWG 8/4	2x AWG 8/4	-	-		
230	52.6	2x AWG 8/4	2x AWG 8/4	-	-		
460	26.3	AWG 8/4	AWG 14/7	AWG 8/4 + AWG 14/4	AWG 14/7 + AWG 14/4		
575	21.0	AWG 10/4	AWG 14/7	AWG 10/4 + AWG 14/4	AWG 14/7 + AWG 14/4		
starting current DOL start : 5.0 x rated current							
starting current YD start : 1.7 x rated current						* other voltages on request	