

Type: Submersible Duplex mixer
 Application: Prevent the accumulation of solids and floating crusts.

Mixer

Effective area up to Ø6 m
 Impeller diameter 105 mm
 Electrical power in clean water 1.8 kW
 Weight 43 kg

Motor

Mains: **60Hz – 3 phase**
 Rated shaft power 1.75 kW
 Rated electrical power 2.4 kW
 Nominal speed 1700 rpm
 Motor efficiency 71 %
 Power factor (cos phi) 0.85
 Degree of protection IP 68
 Isolation class F (155°C)
 Max. water temperature 40°C
 Standard cable length 10 m



Materials

Impeller AISI 329
 Motor unit parts AISI 329
 Pump shaft AISI 316
 Pump support AISI 316
 Bolts AISI 316
 Rubber parts Viton (FPM)
 Electrical cable Neoprene (CR)
 Seal lubrication Oil
 Seal pump side Silicon carbide – silicon carbide-Viton
 Seal motor side Carbon - ceramic

Optional

- Flameproof version, to class: II 2 G Ex b c d IIB T4 Gb
 With Frequency control: II 2 G Ex b c d IIB T3 Gb
- Thermo switches in motor windings (standard for flameproof version)
- Cable protection sheet (AISI316)
- Water detector in motor and oil chamber
 Flameproof version with external cable
- Heavy duty support (AISI316)

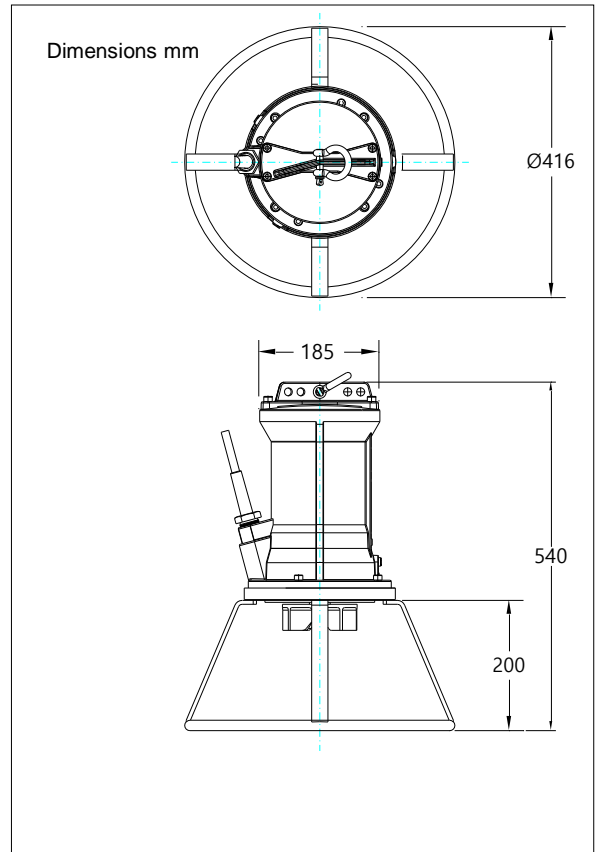

Connections

		electrical cable size		motor protection and/or water detector		flameproof version	
voltage	current						
[V]*	[A]	direct start		direct start		direct start	
220	7.5	4G1.5		7G1.5		7G1.5	
460	3.6	4G1.5		7G1.5		7G1.5	
575	2.9	4G1.5		7G1.5		7G1.5	
starting current DOL start : 4.8 x rated current							
							* other voltages on request

Type: Submersible Duplex mixer
 Application: Prevent the accumulation of solids and floating crusts.

Mixer

Effective area up to Ø8 m
 Impeller diameter 115 mm
 Electrical power in clean water 3.1 kW
 Weight 43 kg

Motor

Mains: 60Hz – 3 phase
 Rated shaft power 2.5 kW
 Rated electrical power 3.6 kW
 Nominal speed 1650 rpm
 Motor efficiency 71 %
 Power factor (cos phi) 0.89
 Degree of protection IP 68
 Isolation class F (155°C)
 Max. water temperature 40°C
 Standard cable length 10 m



Materials

Impeller AISI 329
 Motor unit parts AISI 329
 Pump shaft AISI 316
 Pump support AISI 316
 Bolts AISI 316
 Rubber parts Viton (FPM)
 Electrical cable Neoprene (CR)
 Seal lubrication Oil
 Seal pump side Silicon carbide – silicon carbide-Viton
 Seal motor side Carbon - ceramic

Optional

- Flameproof version, to class: II 2 G Ex b c d IIB T4 Gb
 With Frequency control: II 2 G Ex b c d IIB T3 Gb
- Thermo switches in motor windings (standard for flameproof version)
- Cable protection sheet (AISI316)
- Water detector in motor and oil chamber
 Flameproof version with external cable
- Heavy duty support (AISI316)

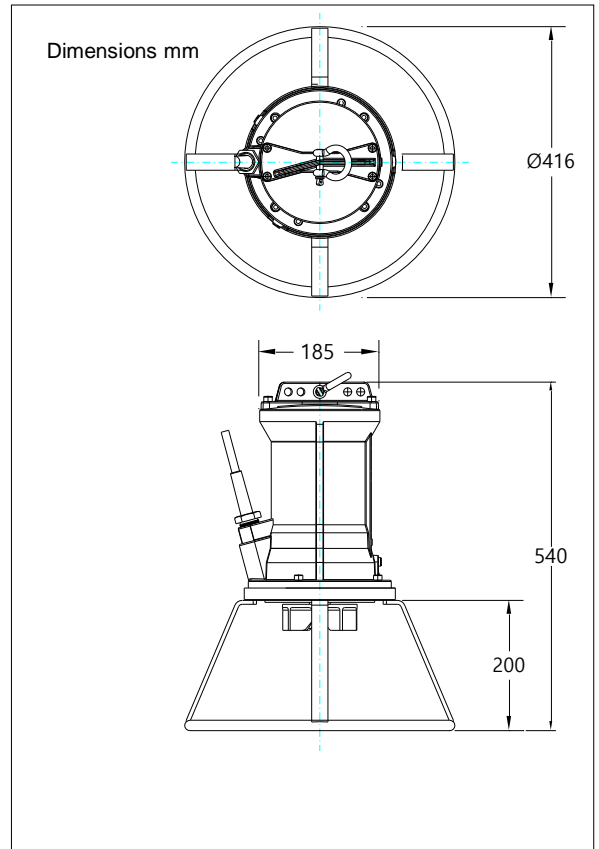

Connections

voltage	current	electrical cable size		motor protection and/or water detector		flameproof version	
		direct start	star-delta start	direct start	star-delta start	direct start	star-delta start
220	10.5	4G1.5	7G1.5	7G1.5	12G1.5	7G1.5	12G1.5
460	5.0	4G1.5	7G1.5	7G1.5	12G1.5	7G1.5	12G1.5
575	4.0	4G1.5	7G1.5	7G1.5	12G1.5	7G1.5	12G1.5
starting current DOL start : 3.4 x rated current							
starting current YD start : 1.1 x rated current						* other voltages on request	

Type: Submersible Duplex mixer
 Application: Prevent the accumulation of solids and floating crusts.

Mixer

Effective area up to Ø10 m
 Impeller diameter 125 mm
 Electrical power in clean water 4.5 kW
 Weight 47 kg

Motor

Mains: 60Hz – 3 phase
 Rated shaft power 4.0 kW
 Rated electrical power 5.2 kW
 Nominal speed 1660 rpm
 Motor efficiency 77 %
 Power factor (cos phi) 0.85
 Degree of protection IP 68
 Isolation class F (155°C)
 Max. water temperature 40°C
 Standard cable length 10 m



Materials

Impeller AISI 329
 Motor unit parts AISI 329
 Pump shaft AISI 316
 Pump support AISI 316
 Bolts AISI 316
 Rubber parts Viton (FPM)
 Electrical cable Neoprene (CR)
 Seal lubrication Oil
 Seal pump side Silicon carbide – silicon carbide-Viton
 Seal motor side Carbon - ceramic

Optional

- Flameproof version, to class: II 2 G Ex b c d IIB T4 Gb
 With Frequency control: II 2 G Ex b c d IIB T3 Gb
- Thermo switches in motor windings (standard for flameproof version)
- Cable protection sheet (AISI316)
- Water detector in motor and oil chamber
 Flameproof version with external cable
- Heavy duty support (AISI316)

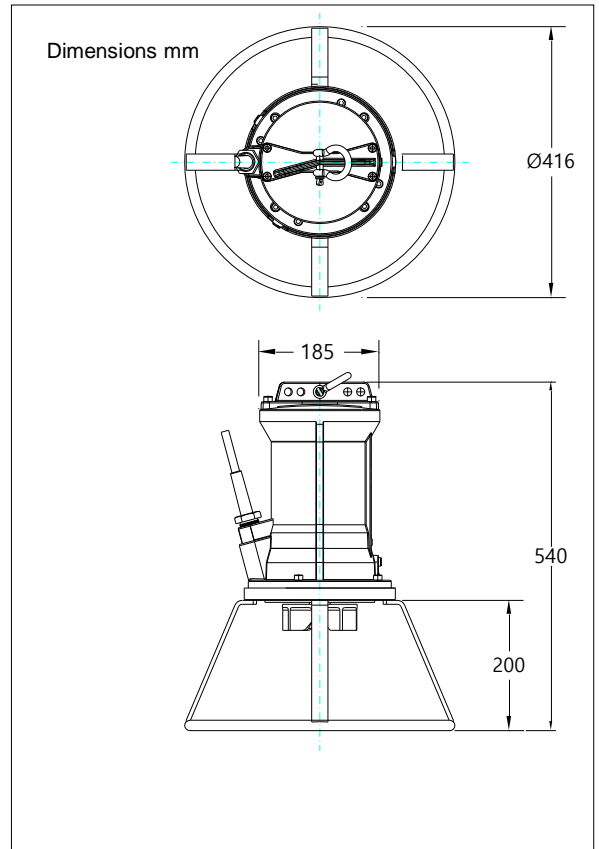

Connections

voltage	current	electrical cable size		motor protection and/or water detector		flameproof version	
		direct start	star-delta start	direct start	star-delta start	direct start	star-delta start
220	16.1	4G2.5	7G1.5	7G2.5	12G1.5	7G2.5	12G1.5
460	7.7	4G1.5	7G1.5	7G1.5	12G1.5	7G1.5	12G1.5
575	6.2	4G1.5	7G1.5	7G1.5	12G1.5	7G1.5	12G1.5
starting current DOL start : 4.3 x rated current							
starting current YD start : 1.4 x rated current						* other voltages on request	

Type: Submersible Duplex mixer
 Application: Prevent the accumulation of solids and floating crusts.

Mixer

Effective area up to Ø14 m
 Impeller diameter 135 mm
 Electrical power in clean water 8.1 kW
 Weight 85 kg

Motor

Mains: **60Hz** – 3 phase
 Rated shaft power 6.9 kW
 Rated electrical power 8.8 kW
 Nominal speed 1674 rpm
 Motor efficiency 78 %
 Power factor (cos phi) 0.85
 Degree of protection IP 68
 Isolation class F (155°C)
 Max. water temperature 40°C
 Standard cable length 10 m

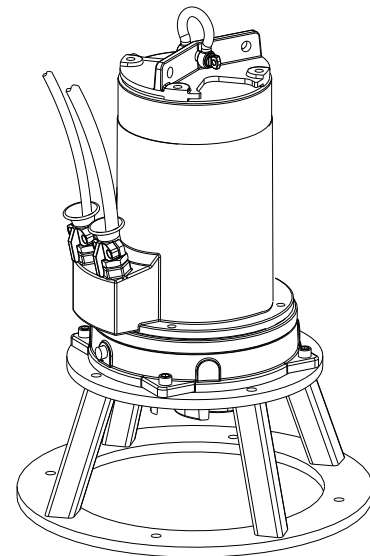

Materials

Impeller AISI 329
 Motor unit parts AISI 329
 Pump shaft AISI 316
 Pump support AISI 316
 Bolts AISI 316
 Rubber parts Viton (FPM)
 Electrical cable Neoprene (CR)
 Seal lubrication Oil
 Seal pump side Silicon carbide – silicon carbide-Viton
 Seal motor side Carbon - ceramic

Optional

- Flameproof version, to class: II 2 G Ex b c d IIB T4 Gb
 With Frequency control: II 2 G Ex b c d IIB T3 Gb
- Thermoswitches in motor windings (standard for flameproof version)
- Cable protection sheet (AISI316)
- Water detector in motor and oil chamber
 Flameproof version with external cable

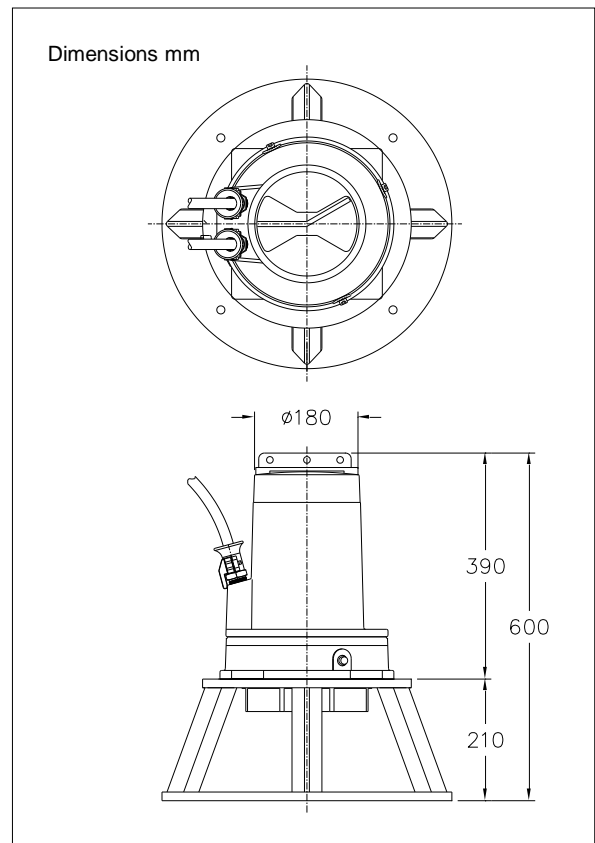

Connections

voltage	current	electrical cable size		motor protection and/or water detector		flameproof version	
		directe start	ster-driehoek start	directe start	ster-driehoek start	directe start	ster-driehoek start
220	27.3	4G6	7G1.5	4G6 + 4G1.5	12G1.5	4G6 + 4G2.5	12G1.5
460	13.1	4G2.5	7G1.5	7G1.5	12G1.5	7G1.5	12G1.5
575	10.5	4G2.5	7G1.5	7G1.5	12G1.5	7G1.5	12G1.5
starting current DOL start : 4.2 x rated current							
starting current YD start : 1.5 x rated current						* other voltages on request	

Type: Submersible Duplex mixer
 Application: Prevent the accumulation of solids and floating crusts.

Mixer

Effective area up to Ø16 m
 Impeller diameter 140 mm
 Electrical power in clean water 9.9 kW
 Weight 87 kg

Motor

Mains: **60Hz** – 3 phase
 Rated shaft power 8.6 kW
 Rated electrical power 10.6 kW
 Nominal speed 1668 rpm
 Motor efficiency 81 %
 Power factor (cos phi) 0.87
 Degree of protection IP 68
 Isolation class F (155°C)
 Max. water temperature 40°C
 Standard cable length 10 m

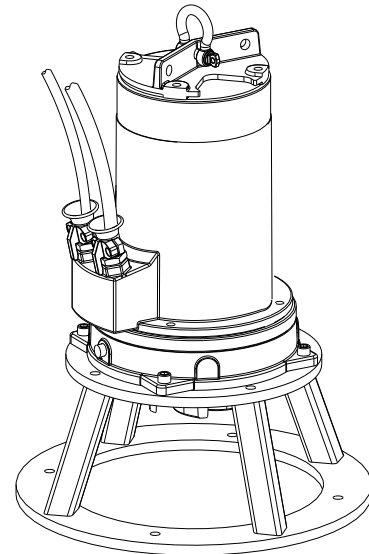

Materials

Impeller AISI 329
 Motor unit parts AISI 329
 Pump shaft AISI 316
 Pump support AISI 316
 Bolts AISI 316
 Rubber parts Viton (FPM)
 Electrical cable Neoprene (CR)
 Seal lubrication Oil
 Seal pump side Silicon carbide – silicon carbide-Viton
 Seal motor side Carbon - ceramic

Optional

- Flameproof version, to class: II 2 G Ex b c d IIB T4 Gb
 With Frequency control: II 2 G Ex b c d IIB T3 Gb
- Thermoswitches in motor windings (standard for flameproof version)
- Cable protection sheet (AISI316)
- Water detector in motor and oil chamber
 Flameproof version with external cable

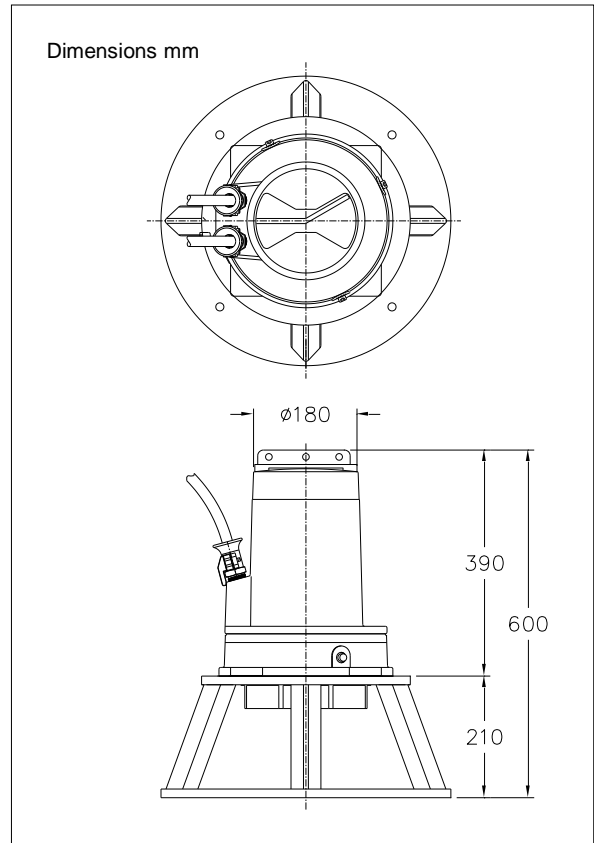

Connections

voltage	current	electrical cable size		motor protection and/or water detector		flameproof version	
		directe start	ster-driehoek start	directe start	ster-driehoek start	directe start	ster-driehoek start
220	32.1	4G6	7G2.5	4G6 + 4G1.5	7G2.5 + 4G1.5	4G6 + 4G2.5	7G2.5 + 4G2.5
460	15.4	4G2.5	7G1.5	7G1.5	12G1.5	7G1.5	12G1.5
575	12.3	4G2.5	7G1.5	7G1.5	12G1.5	7G1.5	12G1.5
starting current DOL start : 6.1 x rated current							
starting current YD start : 2.0 x rated current						* other voltages on request	

Type: Submersible Duplex mixer
 Application: Prevent the accumulation of solids and floating crusts.

Mixer

Effective area up to Ø18 m
 Impeller diameter 155 mm
 Electrical power in clean water 15.5 kW
 Weight 102 kg

Motor

Mains: **60Hz** – 3 phase
 Rated shaft power 14.9 kW
 Rated electrical power 17.5 kW
 Nominal speed 1704 rpm
 Motor efficiency 85 %
 Power factor (cos phi) 0.84
 Degree of protection IP 68
 Isolation class F (155°C)
 Max. water temperature 40°C
 Standard cable length 10 m

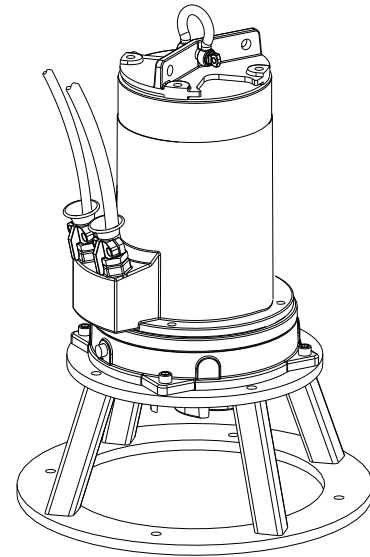

Materials

Impeller AISI 329
 Motor unit parts AISI 329
 Pump shaft AISI 316
 Pump support AISI 316
 Bolts AISI 316
 Rubber parts Viton (FPM)
 Electrical cable Neoprene (CR)
 Seal lubrication Oil
 Seal pump side Silicon carbide – silicon carbide-Viton
 Seal motor side Carbon - ceramic

Optional

- Flameproof version, to class: II 2 G Ex b c d IIB T4 Gb
 With Frequency control: II 2 G Ex b c d IIB T3 Gb
- Thermoswitches in motor windings (standard for flameproof version)
- Cable protection sheet (AISI316)
- Water detector in motor and oil chamber
 Flameproof version with external cable

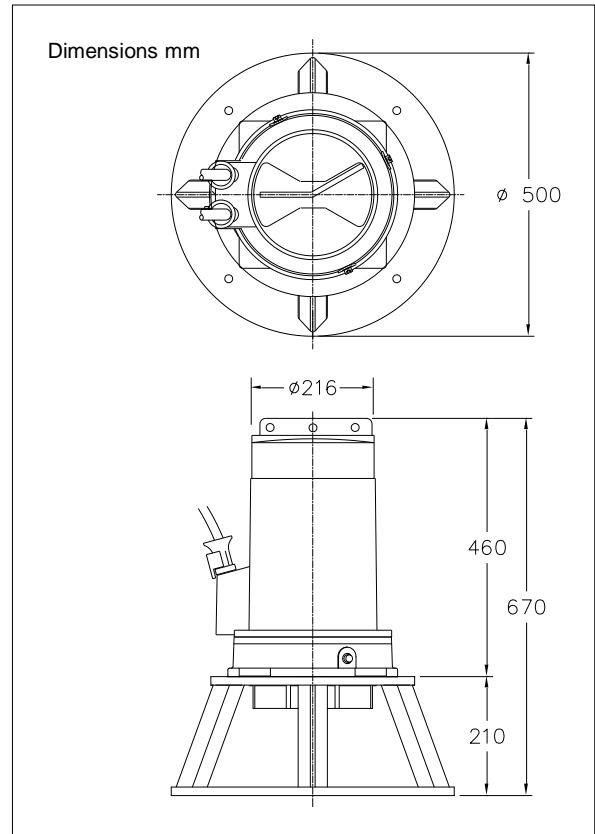

Connections

voltage	current	electrical cable size		motor protection and/or water detector		flameproof version	
		directe start	ster-driehoek start	directe start	ster-driehoek start	directe start	ster-driehoek start
220	55.0	2x 4G6	2x 4G6	-	-	-	-
460	26.3	4G6	7G2.5	4G6 + 4G1.5	7G2.5 + 4G1.5	4G6 + 4G2.5	7G2.5 + 4G2.5
575	21.0	4G2.5	7G1.5	7G2.5	12G1.5	7G2.5	12G1.5
starting current DOL start : 5.0 x rated current							
starting current YD start : 1.7 x rated current				* other voltages on request			